

City of Sacramento
Disabilities Advisory Commission Report
915 I Street Sacramento, CA 95814
www.cityofsacramento.org

File ID: 2026-00957

5/6/2026

Florin Road Vision Zero Safety Project (T15215800)

File ID: 2026-00957

Location: Florin Road from 24th Street to Franklin Boulevard, District 5 and 8

Recommendation: Review and comment.

Contact: Ricardo Navarro, Assistant Civil Engineer, (916) 642-4854, rnavarro@cityofsacramento.org, Public Works Department

Presenter: Ricardo Navarro, Assistant Civil Engineer, (916) 642-4854, rnavarro@cityofsacramento.org, Public Works Department

Attachments:

- 1-Description/Analysis
- 2-30% Plans
- 3-Presentation

Description/Analysis

Issue Detail:

Florin Road between 24th Street and Munson Way is identified in the City's Vision Zero Action Plan as one of the top five high-injury corridors and was studied in detail in the Vision Zero Top 5 Corridors Study. The Florin Road Vision Zero Safety Project (T15215800) represents the second of two phases implementing the study's recommendations.

Phase 1 resurfaced the corridor to bring pavement conditions to a state of good repair, closed gaps in the bicycle network, modernized signal equipment, and installed underground infrastructure needed for future signal upgrades. Phase 2 will deliver additional bicycle lane coverage, sidewalk improvements, new and upgraded signalized pedestrian crossings, improvements at Union Pacific Railroad crossings, and advanced dilemma-zone detection at key intersections. These enhancements are intended to reduce collisions by slowing vehicle speeds, upgrading traffic signal technology, and improving pedestrian and bicycle facilities.

The project requires extensive coordination between the Transportation and Engineering Services Divisions, including transportation planning, traffic operations, project development, and civil and electrical design. Although the project's primary purpose is safety, staff are briefing the Disability Advisory Commission (DAC) because the project will deliver significant Americans with Disabilities

Act (ADA) improvements consistent with the Barden settlement. Phase 2 will upgrade 18 existing and new crosswalks with accessible pedestrian signals and pedestrian signal indicators and construct 16 new ADA-compliant curb ramps.

The project is currently in the preliminary engineering phase, and staff are seeking the Commission's review and feedback on the proposed accessibility and safety improvements. Construction is anticipated to begin in Summer 2027.

Policy Considerations: The Project is consistent with the following policies from the Sacramento General Plan:

1. M-1: An equitable, sustainable multimodal system that provides a range of viable and healthy travel choices for users of all ages, backgrounds, and abilities.
2. M-1.2 User Prioritization. The City shall prioritize mobility, comfort, health, safety, and convenience for those walking, followed by those bicycling and riding transit, ahead of design and operations for those driving.
3. M-1.11 Increase Bicycling and Walking. The City shall strive to increase bicycling and walking citywide so that it can meet its equity, reduced vehicle miles traveled, and sustainability goals.
4. M-3.3 Traffic. The City shall support planning and managing traffic from the perspective of the adjacent uses, using traffic management and traffic calming techniques.
5. M-4.1 Application of Safety. The City shall design, plan, and operate streets using complete streets principles to ensure the safety and mobility of all users.
6. M-4.2 Safer Driving Speeds. The City shall work to maximize the safety of the transportation network by designing streets for lower driving speeds and enforcing speed limits in an unbiased manner as well as promoting safer driving behavior.
7. M-4.3 Vision Zero. The City shall utilize a data driven, "vision zero" approach to eliminate all traffic fatalities and severe injuries by 2027, while increasing safety, health, and equitable mobility for all.

Economic Impacts: Not applicable.

Environmental Considerations:

California Environmental Quality Act (CEQA): The City of Sacramento Environmental Planning Services has reviewed this project and determined that it is exempt from the provisions of CEQA under Class 1, Section Number 15301 which consists of the operation, repair, maintenance, or minor alteration of existing public or private structures or facilities involving negligible or no expansion of existing or former use.

National Environmental Policy Act (NEPA): The California Department of Transportation (Caltrans) has reviewed this project and determined that it is excluded from the provisions of NEPA under 23 CFR 771.117(c), activity 3, which consists of the construction of bicycle and pedestrian lanes, paths, and facilities.

Sustainability: The Project is consistent with the City of Sacramento's Vision Zero Action Plan with goals to improve and optimize the City's transportation infrastructure for bicyclists and pedestrians. The project will reduce dependence on private automobiles, decrease the use of fossil fuels, and encourage active modes of transportation.

Commission/Committee Action: Not applicable.

Rationale for Recommendation: This item is for information only. Preliminary engineering is expected to be completed by 2027. Community and commission feedback is an important part in finalizing the scope before further design.

Financial Considerations: Not applicable.

Public/Neighborhood Outreach and Comments: The City participated in public events on March 15, 2025, and March 21, 2026 that discussed the implementation of the overall Florin Road Vision Zero Effort. The community is highly supportive of the safety improvements on the corridor.

GENERAL NOTES:

- ALL CONSTRUCTION SHALL CONFORM TO THE CITY OF SACRAMENTO STANDARD SPECIFICATIONS, DATED NOVEMBER 2020, AND ALL UPDATES, ADDENDUMS AND MEMORANDUMS TO THEM.
- THE CONTRACTOR SHALL SUBMIT TO THE RESIDENT ENGINEER A COMPLETED CONSTRUCTION STAKING REQUEST FORM THREE WORKING DAYS PRIOR TO PROJECT STAKING. THE AREA MUST BE CLEAR AS OF THE "AREA READY FOR STAKES" DATE. NO STOCK PILES, EQUIPMENT, WORK OR OTHER THINGS THAT WOULD INTERFERE WITH THE PLACEMENT OF OFFSETS OR LINE OF SIGHT FOR SETTING STAKES SHALL BE ALLOWED.
- THE CONTRACTOR SHALL BE SOLELY RESPONSIBLE FOR FURNISHING, INSTALLING AND MAINTAINING ALL WARNING SIGNS AND DEVICES NECESSARY TO SAFEGUARD THE GENERAL PUBLIC AND THE WORK AND FOR PROVIDING PROPER AND SAFE ROUTING OF THE VEHICULAR AND PEDESTRIAN TRAFFIC DURING THE PERFORMANCE OF THE WORK. THIS REQUIREMENT SHALL APPLY CONTINUOUSLY AND SHALL NOT BE LIMITED TO WORKING HOURS. THE USE OF FLAGGERS, BARRICADES AND CONSTRUCTION SIGNING SHALL COMPLY WITH THE CURRENT CALIFORNIA MANUAL ON UNIFIED TRAFFIC CONTROL DEVICES (CA MUTCD).
- THE CONTRACTOR IS RESPONSIBLE FOR DETERMINING THE LOCATION OF ALL EXISTING UTILITIES AND PROTECTING AND REPAIRING DAMAGE TO EXISTING UTILITIES. THE CONTRACTOR SHALL CONTACT UNDERGROUND SERVICE ALERT (1-800-642-2444) TWO WORKING DAYS PRIOR TO WORK COMMENCEMENT.
- THE CONTRACTOR SHALL MAINTAIN ALL EXISTING WATER, DRAINAGE AND SEWER FACILITIES WITHIN THE CONSTRUCTION AREA UNTIL THE PROPOSED WATER, DRAINAGE AND/OR SEWER IMPROVEMENTS ARE PLACED AND FUNCTIONING.
- DEMOLITION OF EXISTING FEATURES SHALL BE LIMITED TO THE ITEMS SHOWN ON THE PLANS AND DESCRIBED IN THE SPECIAL PROVISIONS. IT SHALL BE THE CONTRACTOR'S RESPONSIBILITY TO REPAIR AND/OR REPLACE ALL EXISTING FEATURES DAMAGED BY HIS OPERATIONS, AT THE CONTRACTOR'S EXPENSE.
- AT THE TIME THE CONTRACT IS AWARDED, THE CONTRACTOR SHALL POSSESS A CLASS "A" LICENSE, OR A COMBINATION OF CLASSES REQUIRED BY THE CATEGORIES AND CLASSES OF WORK INCLUDED IN THIS CONTRACT.
- ALL CURB, GUTTER, AND SIDEWALK SHOWN TO BE REMOVED SHALL BE REMOVED TO THE NEAREST EXPANSION JOINT OR SCORE MARK. DAMAGE TO EXISTING CURB, GUTTER AND SIDEWALK WHICH IS SHOWN ON THE PLANS TO REMAIN, SHALL BE REPAIRED AT THE CONTRACTOR'S EXPENSE.
- THE CONTRACTOR SHALL OBTAIN A PERMIT FROM THE DIVISION OF OCCUPATIONAL SAFETY & HEALTH (2424 ARDEN WAY SUITE 165, SACRAMENTO, CA PHONE 263-2800) PRIOR TO ANY TRENCHING EXCAVATION 5 FEET OR MORE IN DEPTH. A COPY OF THIS PERMIT SHALL BE AVAILABLE AT THE CONSTRUCTION SITE AT ALL TIMES.
- THE CONTRACTOR SHALL BE COMPLETELY RESPONSIBLE FOR PRESERVING ALL EXISTING MONUMENTS WHICH WILL BE DISTURBED OR REMOVED AS REQUIRED BY CONTRACTOR'S WORK. CONTRACTOR SHALL COORDINATE WITH ENGINEER/SURVEYOR PRIOR TO DISTURBANCE OF EXISTING MONUMENTS, AND SHALL RESET MONUMENTS OR PROVIDE PERMANENT WITNESS MONUMENTS AND FILE DOCUMENTATION WITH THE COUNTY SURVEYOR PURSUANT TO BUSINESS AND PROFESSIONS CODE SECTION 8771.
- THE CONTRACTOR, SUBCONTRACTOR OR SURVEYOR SHALL NOT CUT PERMANENT CROSSES INTO EXISTING CONCRETE CURBS, GUTTERS OR SIDEWALKS. THE CONTRACTOR SHALL BE ASSESSED AN ADMINISTRATIVE PENALTY OF \$500 FOR EACH CROSS THAT IS CUT PERMANENTLY INTO EXISTING CONCRETE CURBS, GUTTERS AND SIDEWALKS.

CITY OF SACRAMENTO

IMPROVEMENT PLANS FOR

FLORIN ROAD VISION ZERO

PN: XX

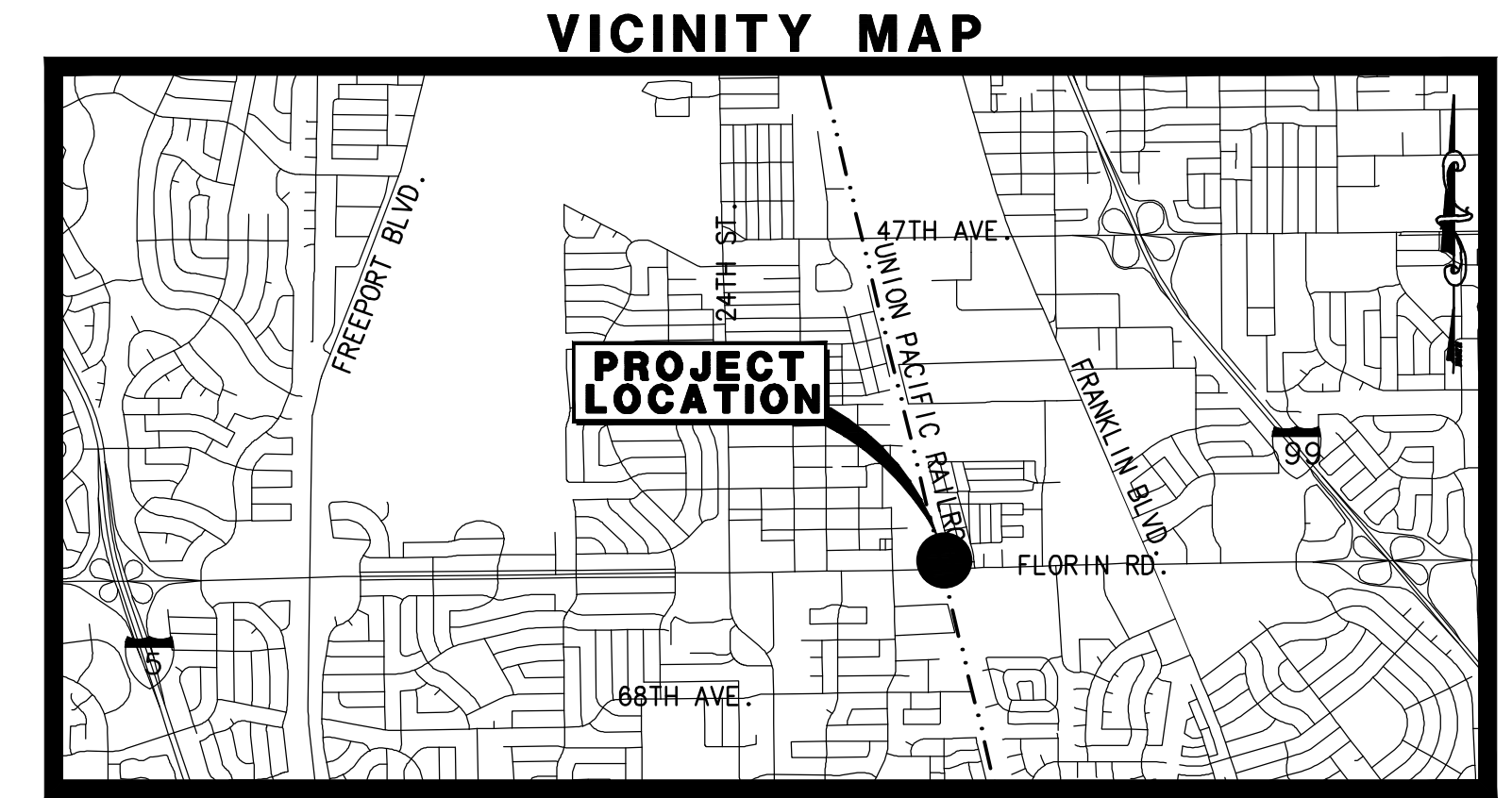

APPROVED BY: _____ DATE _____
 JUDY MATSUI-DRURY R.C.E 59096
 SUPERVISING ENGINEER
 DEPARTMENT OF PUBLIC WORKS

APPROVED BY: _____ DATE _____
 KALEB HAILE R.E.E 15137
 SENIOR ELECTRICAL ENGINEER
 DEPARTMENT OF PUBLIC WORKS

APPROVED BY: _____ DATE _____
 DAVID EDROSOLAN R.C.E 50826
 CITY TRAFFIC ENGINEER
 (SIGNING AND STRIPING ONLY)
 DEPARTMENT OF PUBLIC WORKS

LEGEND		
DESCRIPTION	EXISTING	PROPOSED
SANITARY SEWER	8"SS	
STORM DRAIN	12"SD	
SEWER (SASD)	SASD	
SEWER (SRCS)	RW	
WATER	12"W	
GAS (PG&E)	G	
ELECTRICAL (SMUD)	E	
GAS (SMUD)	SMUD/G	
AT&T	AT&T/D	
AT&T TELEPORT COMMUNICATIONS AMERICA	AT&T/TCA	
COMCAST	CMC	
SUREWEST	CCI	
VERIZON	MCI	
ZAYO GROUP	ZYO	
SACRAMENTO REGIONAL TRANSIT	SRT	
STREET LIGHTING	sl	
TRAFFIC SIGNAL	ts	
FIRE HYDRANT	fh	
WATER VALVE	vw	
GRADE BREAK		GB
WATER METER BOX	wm	
DROP INLET	di	
MANHOLE	mh	
STREET LIGHT (MAST ARM)	sl	
POWER POLE	pp	
PULL BOX	pb	
CG&SW		
CENTER LINE		
RIGHT-OF-WAY		
SAWCUT LINE		SAWCUT
CHAIN LINK FENCE		

SHEET INDEX

T-1	TITLE SHEET
PC-1	PROJECT CONTROL
X-1	TYPICAL SECTIONS
L-1 to L-3	LAYOUTS
SS-1 to SS-4	SIGNING AND STRIPING

STANDARD ABBREVIATIONS

AB	AGGREGATE BASE	L	LENGTH, LEFT
AC	ASPHALTIC CONCRETE OR ACRE	LF	LINEAR FEET
ADA	AMERICAN DISABILITY ACT	LT	LEFT
ADT	AVERAGE DAILY TRAFFIC	MAX	MAXIMUM
AP	ANGLE POINT	MH	MANHOLE
APPROX	APPROXIMATE	MIN	MINIMUM
AVE	AVENUE	MUTCD	MANUAL ON UNIFORM TRAFFIC CONTROL DEVICES
BC	BEGIN HORIZONTAL CURVE	MOD	MODIFIED
Beg	BEGIN	No	NUMBER
BFC	BOTTOM FACE OF CURB	OG	ORIGINAL GROUND
BLDG	BUILDING	OH	OVERHEAD
BLVD	BOULEVARD	PCC	PORTLAND CEMENT CONCRETE
BM	BENCH MARK	PI	POINT OF INTERSECTION
BOC	BACK OF CURB	PG	PROPOSED GRADE
BOW	BACK OF WALK	PRC	POINT OF REVERSE CURVE
C&G	CURB AND GUTTER	PVC	POLYVINYL CHLORIDE
CONC	CONCRETE	PVI	POINT OF VERTICAL INTERSECTION
CL	CENTERLINE, OR CLASS	R	RADIUS, OR RIDGE
CR	CURB RAMP	Rem	REMOVE
CT	CALTRANS	RT	RIGHT
DG	DECOMPOSED GRANITE	R/W	RIGHT OF WAY
DI	DRAIN INLET	S/C	SAWCUT LINE
DR	DRIVE	SD	STORM DRAIN
DWG	DRAWING	SDMH	STORM DRAIN MANHOLE
DWY	DRIVEWAY	SF	SQUARE FEET
(E), Exist	EXISTING	STD	STANDARD
EC	END HORIZONTAL CURVE	SSBM	STRAP AND SADDLE BRACKET METHOD
ELEV	ELEVATION	ST	STREET
ETS	EMISSIONS TRADING SYSTEM	SW	SIDEWALK
FND	FOUND	TFC	TOP FACE OF CURB
FO	FIBER OPTICS	TI	TRAFFIC INDEX
FL	FLOWLINE	TYP	TYPICAL
FW	FACE OF WALK	VAR	VARIABLES
HMA	HOT MIX ASPHALT	W	WATER
HP	HIGH POINT		
INV	PIPE INVERT		

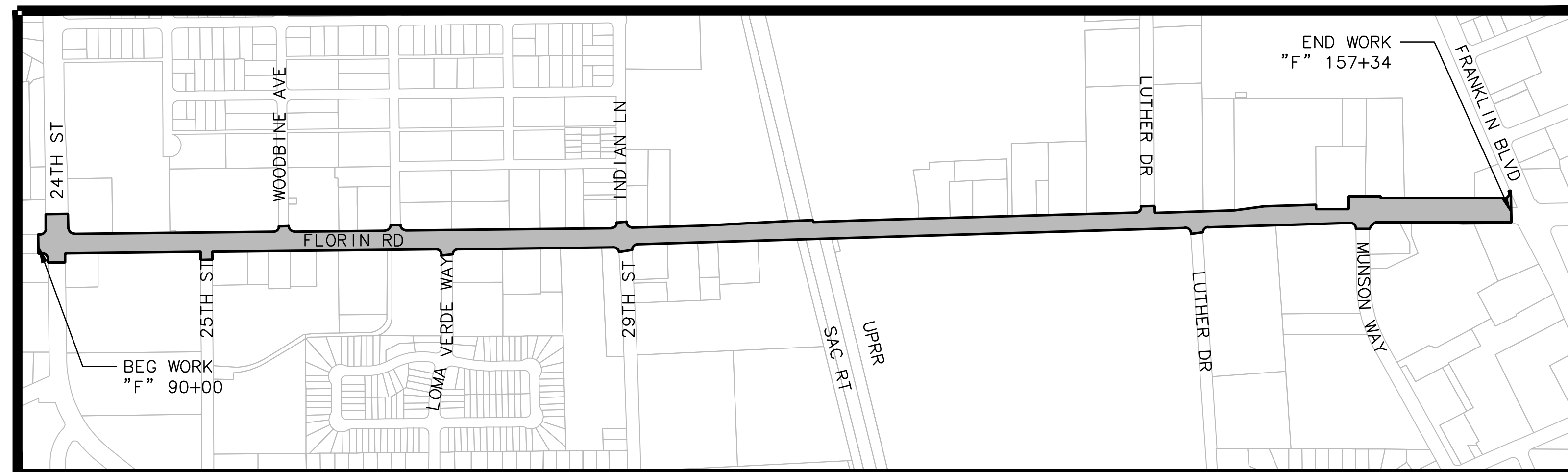

LOCATION MAP

NTS

30% (NOT FOR CONSTRUCTION)

T-1

REVISIONS				BENCH MARK ELEV.	FIELD BOOK
NO.	DESCRIPTION	DATE	BY		

CITY OF SACRAMENTO DEPARTMENT OF PUBLIC WORKS		
SCALE HORIZ. NTS	DRAWN BY: J. FLORDELIZ DATE 12/1/2023	DESIGNED BY: J. FLORDELIZ DATE 12/1/2023
	CHECKED BY: A. SILVA R.C.E. 75938 DATE 12/1/2023	

MARK THOMAS
 UNDER THE SUPERVISION OF:
 AARON SILVA
 R.C.E. 75938
 EXP. 12-31-24

IMPROVEMENT PLANS FOR FLORIN ROAD VISION ZERO	
TITLE SHEET	

SHEET	1
OF	10
PN: XXX	

GENERAL NOTES:

- CONTRACTOR SHALL COMPLY WITH BUSINESS AND PROFESSIONS CODE SECTION 8771 (b) REGARDING REFERENCING, PRESERVING AND RECONSTRUCTION MONUMENTS, WHETHER OR NOT MONUMENTS ARE SHOWN IN THESE PLANS.
- IF MONUMENT IS DAMAGED BY CONTRACTOR'S OPERATIONS, WHETHER OR NOT MONUMENTS ARE SHOWN ON THESE PLANS, CONTRACTOR SHALL REPLACE AT CONTRACTORS COST.

LEGEND:



BASIS OF BEARING

(CITY TO PROVIDE)

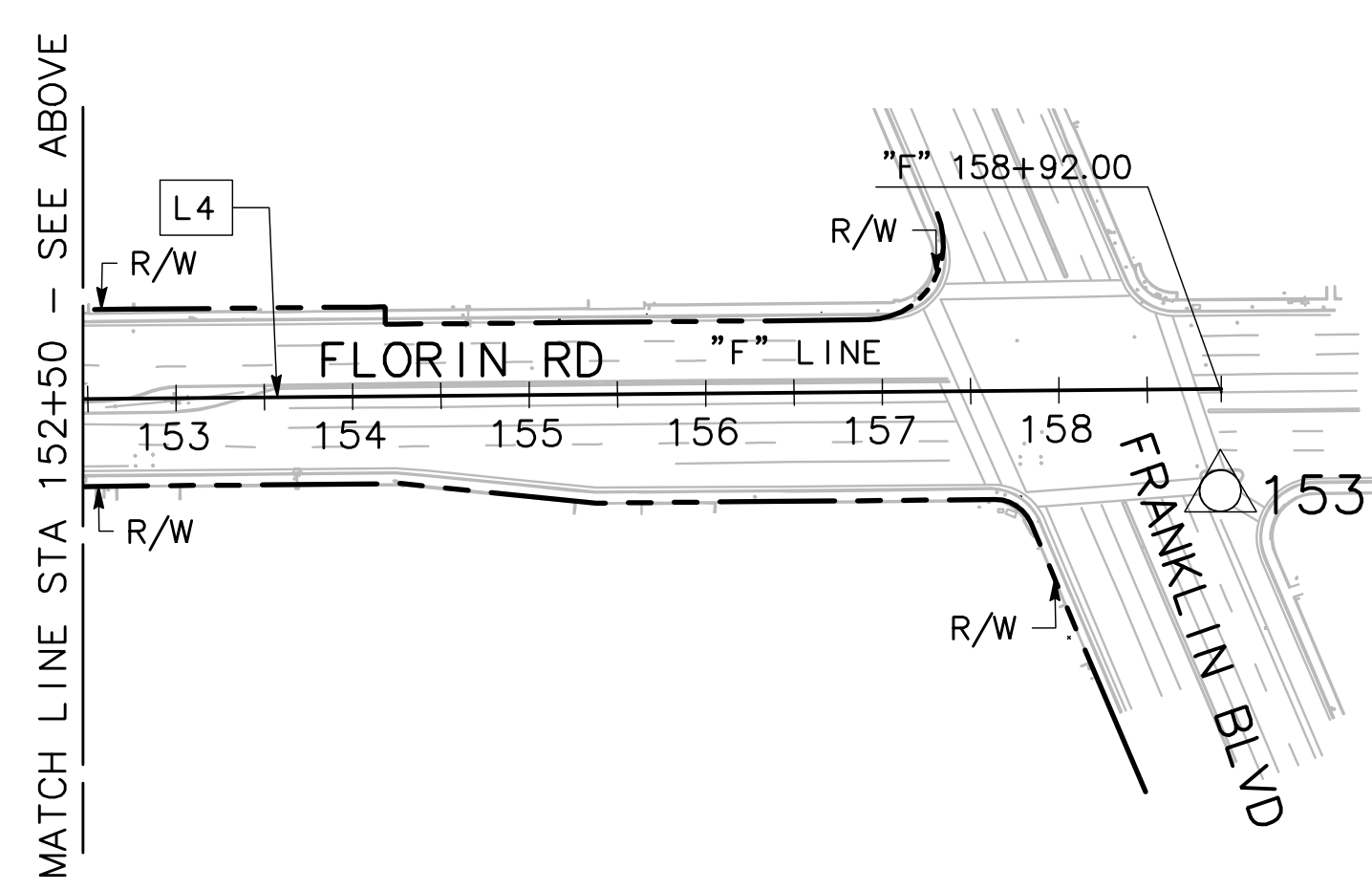
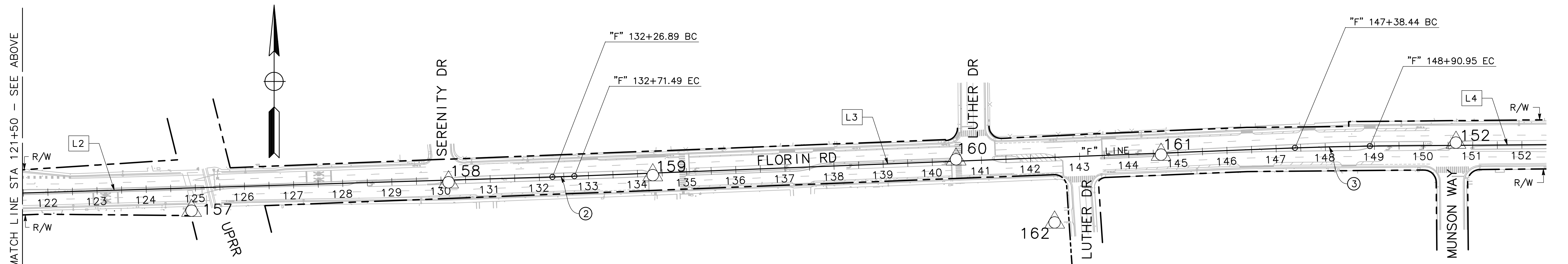
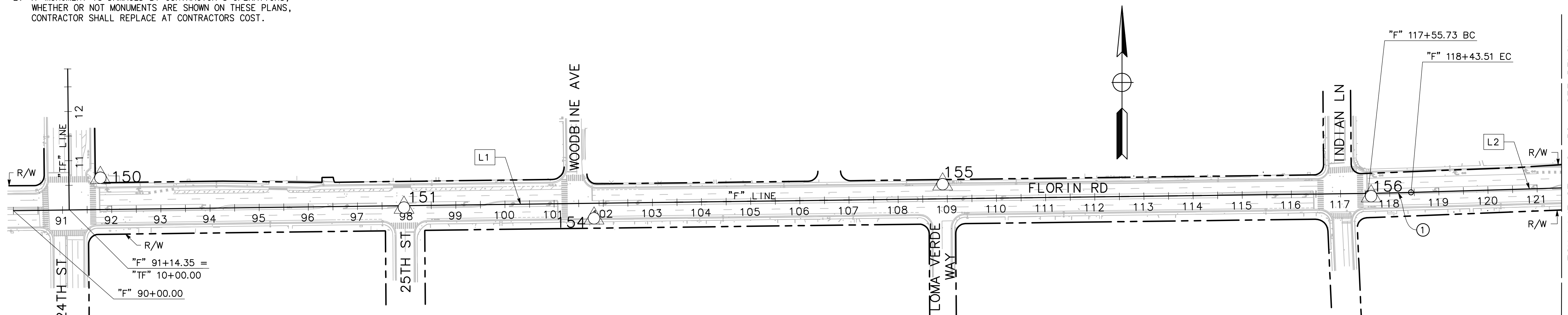

NUMBER	STATION	OFFSET	NORTHING	EASTING	ELEVATION	Description
150	"F" 91+77.70	64.54' Lt	1942856.263	6709772.351	13.76'	REBAR
151	"F" 97+94.53	3.09' Rt	1842796.486	6710389.994	13.90'	MAG NAIL
152	"F" 150+66.18	5.68' Lt	1942938.215	6715659.528	18.91'	MAG NAIL
153	"F" 158+90.42	61.84' Rt	1942877.878	6716484.327	18.41'	MAG NAIL
154	"F" 101+80.77	31.35' Rt	1942773.147	6710776.580	13.29'	MAG NAIL
155	"F" 108+89.27	29.95' Lt	1942843.451	6711484.227	12.40'	MAG NAIL
156	"F" 117+62.28	5.12' Rt	1942819.509	6712357.634	15.57'	MAG NAIL
157	"F" 124+90.81	45.80' Rt	1942800.248	6713087.147	21.55'	MAG NAIL
158	"F" 130+15.14	4.54' Rt	1942857.366	6713609.978	16.82'	MAG NAIL
159	"F" 134+30.82	4.15' Rt	1942871.966	6714025.446	17.01'	MAG NAIL
160	"F" 140+48.73	4.60' Lt	1942904.922	6714642.529	16.52'	MAG NAIL
161	"F" 144+65.69	2.98' Rt	1942913.694	6715059.488	18.12'	MAG NAIL
162	"F" 142+43.86	132.56' Rt	1942775.503	6714842.906	17.33'	PAINT DOT

No. #	BEARING	DISTANCE
L1	89°16'15"	2755.73'
L2	88°15'53"	1383.37'
L3	87°45'13"	1466.95'
L4	89°30'05"	930.06'

No. #	R	Δ	T	L
①	5,000.00	1°00'22"	43.89'	87.79'
②	5,000.00	0°30'40"	22.30'	44.61'
③	5,000.00	1°44'51"	76.26'	152.51'

30% (NOT FOR CONSTRUCTION)

PC-1

REVISIONS				BENCH MARK ELEV. _____	FIELD BOOK
NO.	DESCRIPTION	DATE	BY		

CITY OF SACRAMENTO
DEPARTMENT OF PUBLIC WORKS

SCALE: _____

HORIZ. NTS. _____

VERT. _____

DRAWN BY: J. FLORDELIZ DESIGNED BY: J. FLORDELIZ CHECKED BY: A. SILVA

DATE: 12/1/2023 DATE: 12/1/2023 R.C.E. 75938 DATE: 12/1/2023

MARK THOMAS

UNDER THE SUPERVISION OF:
AARON SILVA

R.C.E. 75938
EXP. 12-31-24

IMPROVEMENT PLANS FOR
FLORIN ROAD VISION ZERO
PROJECT CONTROL

SHEET	2
OF	10
PN: XXX	

GENERAL NOTES:

- FOR ALL LOCATIONS, LIMITS, AND DIMENSIONS OF CURBS, GUTTERS, SIDEWALKS, AND RAISED ISLANDS SEE LAYOUTS AND CONSTRUCTION DETAILS.
- DIMENSIONS OF THE PAVEMENT STRUCTURAL SECTION ARE SUBJECT TO TOLERANCES SPECIFIED IN THE STANDARD SPECIFICATIONS.
- (N) - NOT A SEPARATE PAY ITEM. INCLUDED IN PRICE PAID PER SQUARE FOOT OF MEDIAN TEXTURED PAVING.

DESIGN DESIGNATIONS:

FLORIN ROAD
 R-VALUE = 5
 T.I. VALUE = 7
 DESIGN SPEED
 FLORIN ROAD - 45 MPH

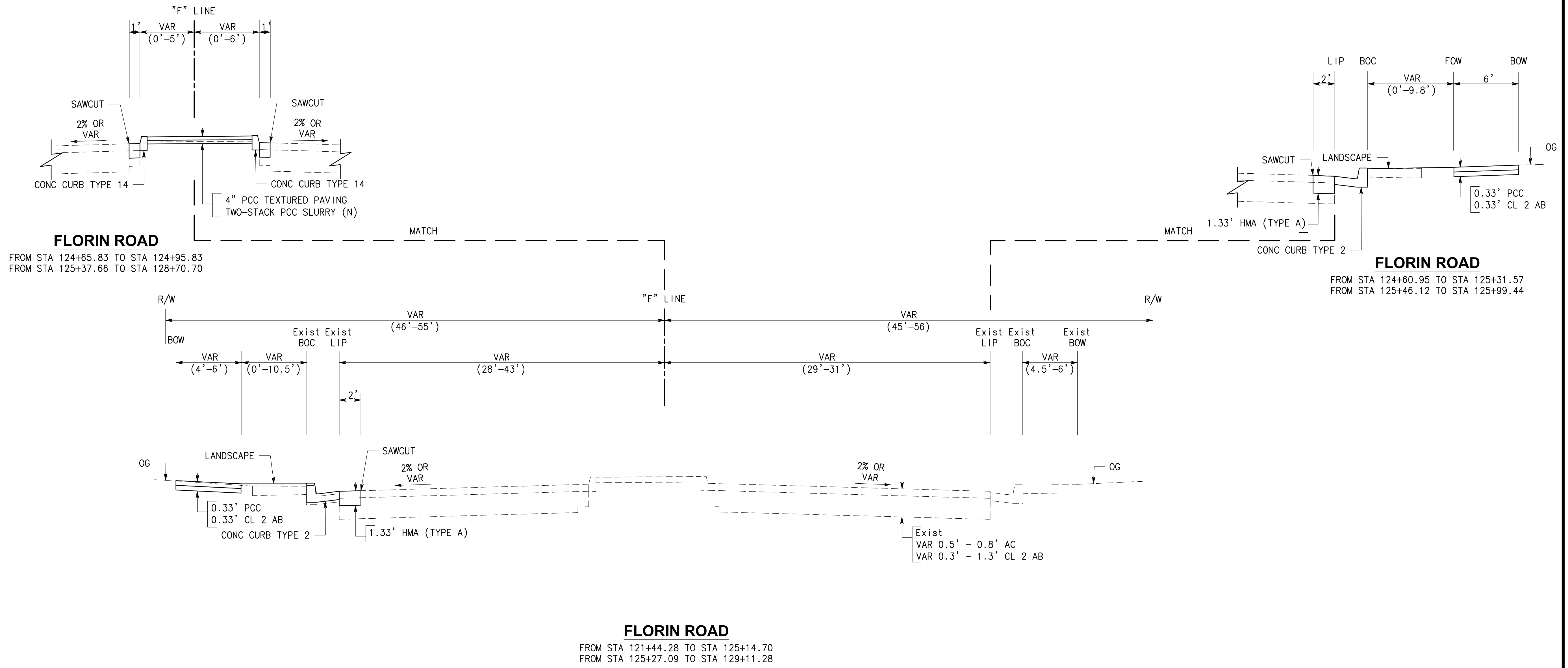





30% (NOT FOR CONSTRUCTION) X-1

REVISIONS NO. DESCRIPTION DATE BY		BENCH MARK ELEV. _____		FIELD BOOK		CITY OF SACRAMENTO DEPARTMENT OF PUBLIC WORKS		MARK THOMAS UNDER THE SUPERVISION OF: AARON SILVA		IMPROVEMENT PLANS FOR FLORIN ROAD VISION ZERO TYPICAL SECTIONS		SHEET 3 OF 10
				SCALE HORIZ. NTS. VERT. _____		DRAWN BY: J. FLODELIZ DATE 12/1/2023		DESIGNED BY: J. FLODELIZ DATE 12/1/2023		CHECKED BY: A. SILVA R.C.E. 75938 DATE 12/1/2023		PN: XXX

GENERAL NOTES:

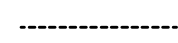
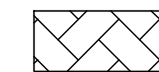
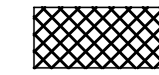
1. ALL STATION AND OFFSET CALLOUTS REFERENCE THE "F" LINE UNLESS OTHERWISE NOTED.
2. STATION AND OFFSET CALLOUTS ARE TO THE FLOWLINE UNLESS OTHERWISE NOTED.

LEGEND:

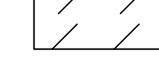
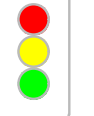
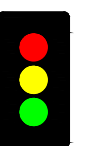
-  BUS STOP LOCATION
-  SAWCUT
-  TEXTURED PAVING
-  REMOVE MEDIAN
-  MINOR CONCRETE
-  DECOMPOSED GRANITE
-  LANDSCAPING
-  SLURRY SEAL
-  Exist TRAFFIC SIGNAL
-  Prop TRAFFIC SIGNAL

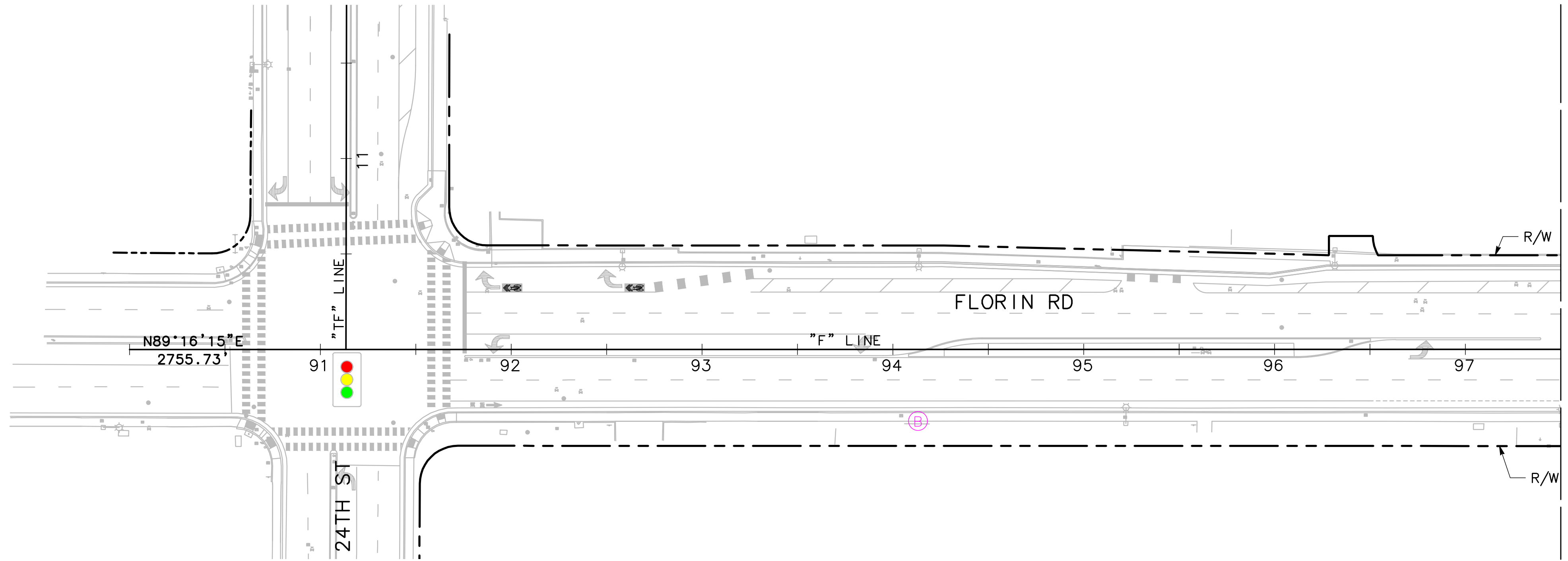
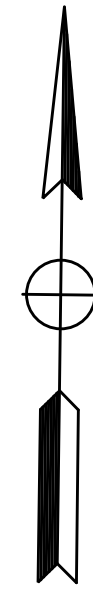

MATCH LINE STA 97+50 - SEE BELOW

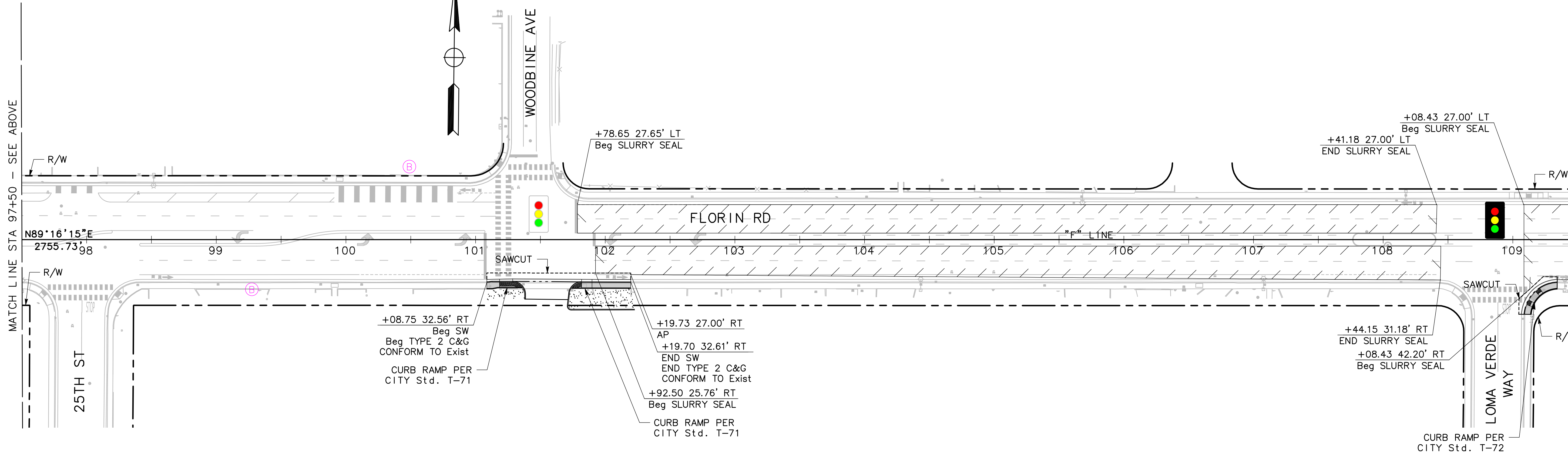
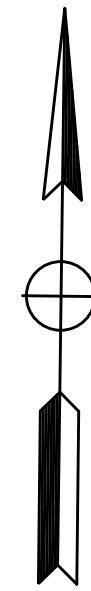

MATCH LINE STA 97+50 - SEE ABOVE

MATCH LINE STA 109+50 - SEE L-2

30% (NOT FOR CONSTRUCTION)

L-1

REVISIONS			
NO.	DESCRIPTION	DATE	BY

BENCH MARK	ELEV.	
------------	-------	--

FIELD BOOK	
SCALE	
HORIZ. 1"=40'	
VERT.	

CITY OF SACRAMENTO DEPARTMENT OF PUBLIC WORKS			
DRAWN BY: J. FLORDELIZ	DESIGNED BY: J. FLORDELIZ	CHECKED BY: A. SILVA	R.C.E. 75938
DATE 12/1/2023	DATE 12/1/2023	DATE 12/1/2023	EXP. 12-31-24

MARK THOMAS

 UNDER THE SUPERVISION OF:
 AARON SILVA

IMPROVEMENT PLANS FOR FLORIN ROAD VISION ZERO LAYOUTS	
---	--

PN: XXX	SHEET	4
	OF	10

GENERAL NOTES:

1. ALL STATION AND OFFSET CALLOUTS REFERENCE THE "F" LINE UNLESS OTHERWISE NOTED.
2. STATION AND OFFSET CALLOUTS ARE TO THE FLOWLINE UNLESS OTHERWISE NOTED.

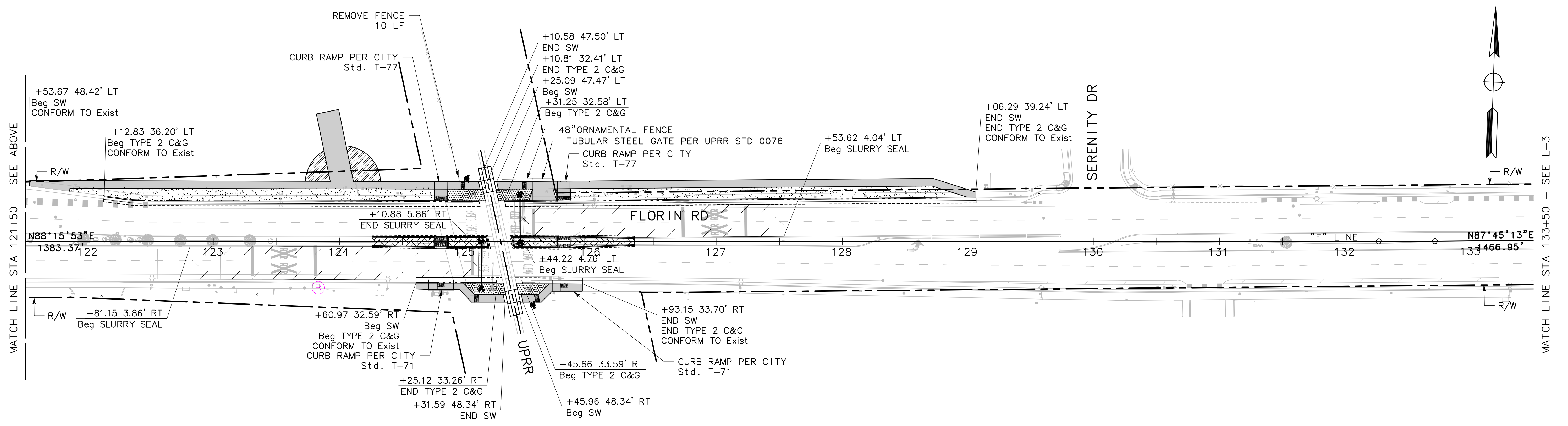
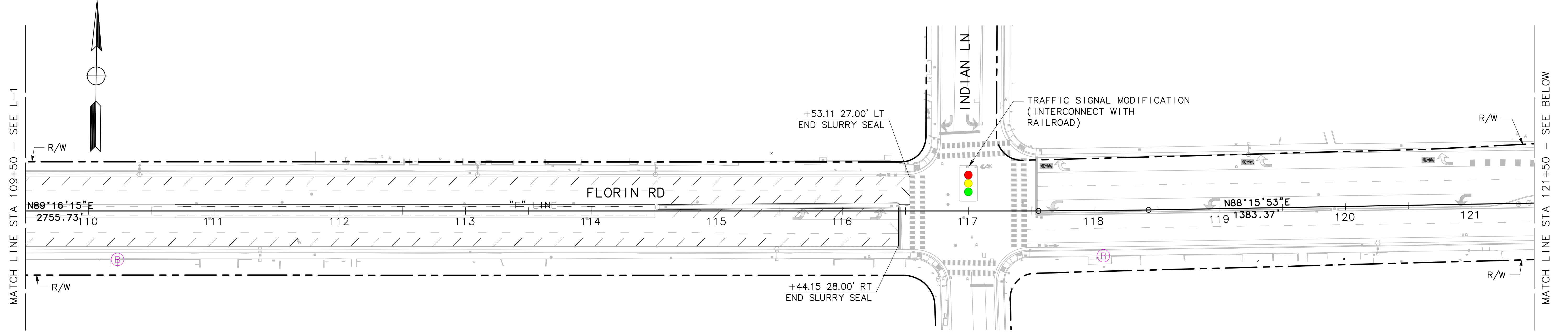

30% (NOT FOR CONSTRUCTION)

L-2

<table border="1"> <thead> <tr> <th colspan="4">REVISIONS</th> </tr> <tr> <th>NO.</th> <th>DESCRIPTION</th> <th>DATE</th> <th>BY</th> </tr> </thead> <tbody> <tr> <td> </td> <td> </td> <td> </td> <td> </td> </tr> <tr> <td> </td> <td> </td> <td> </td> <td> </td> </tr> </tbody> </table>				REVISIONS				NO.	DESCRIPTION	DATE	BY									BENCH MARK ELEV. _____		FIELD BOOK _____		CITY OF SACRAMENTO DEPARTMENT OF PUBLIC WORKS					IMPROVEMENT PLANS FOR FLORIN ROAD VISION ZERO LAYOUTS		SHEET 5 OF 10
REVISIONS																															
NO.	DESCRIPTION	DATE	BY																												
SCALE HORIZ. 1"=40' VERT. _____		DRAWN BY: J. FLORDELIZ DATE 12/1/2023		DESIGNED BY: J. FLORDELIZ DATE 12/1/2023		CHECKED BY: A. SILVA R.C.E. 75938 DATE 12/1/2023		UNDER THE SUPERVISION OF: AARON SILVA		R.C.E. 75938 EXP. 12-31-24		PN: XXX																			

GENERAL NOTES:

1. ALL STATION AND OFFSET CALLOUTS REFERENCE THE "F" LINE UNLESS OTHERWISE NOTED.
2. STATION AND OFFSET CALLOUTS ARE TO THE FLOWLINE UNLESS OTHERWISE NOTED.

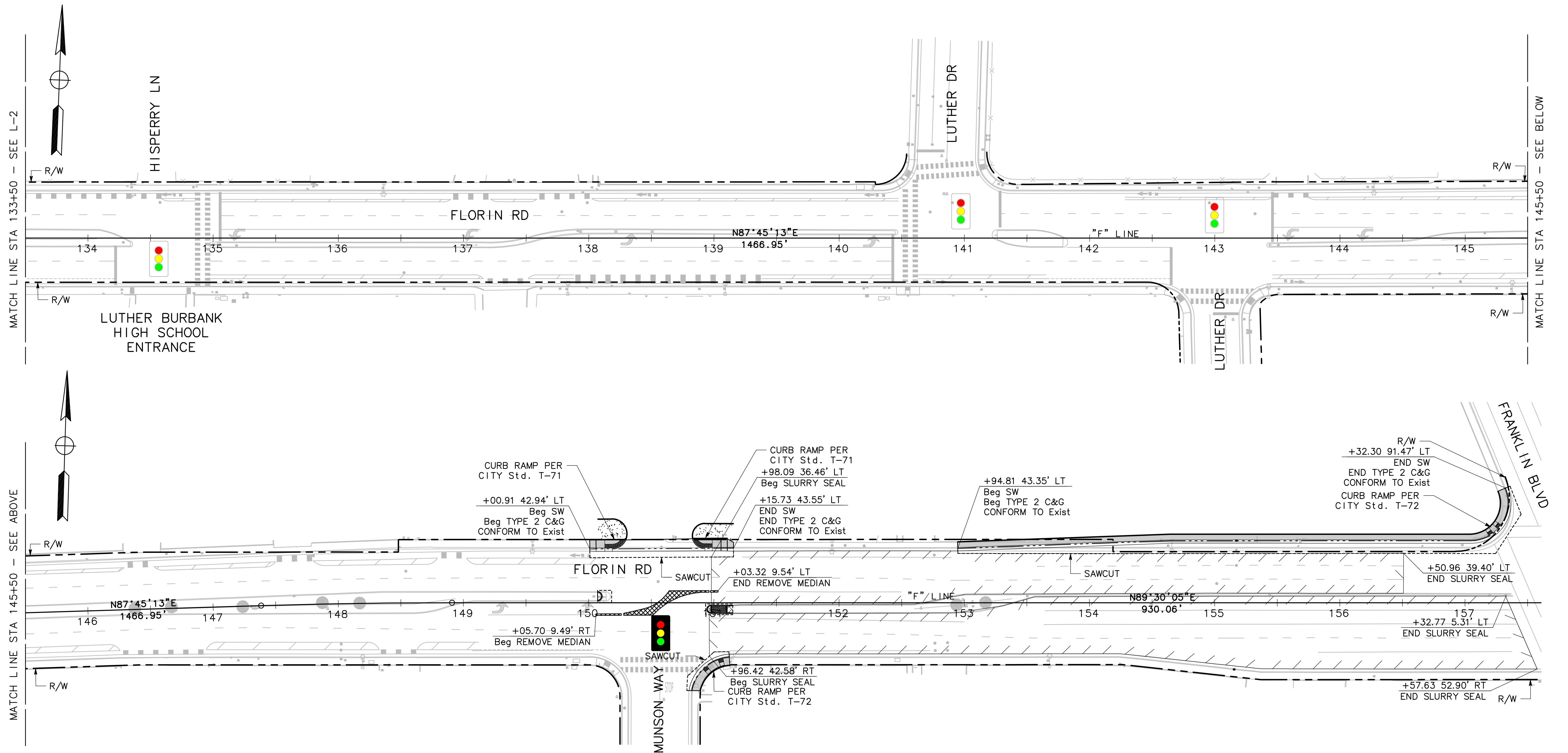

30% (NOT FOR CONSTRUCTION)

L-3

<table border="1"> <thead> <tr> <th colspan="4">REVISIONS</th> </tr> <tr> <th>NO.</th> <th>DESCRIPTION</th> <th>DATE</th> <th>BY</th> </tr> </thead> <tbody> <tr> <td> </td> <td> </td> <td> </td> <td> </td> </tr> <tr> <td> </td> <td> </td> <td> </td> <td> </td> </tr> </tbody> </table>				REVISIONS				NO.	DESCRIPTION	DATE	BY									BENCH MARK ELEV. _____		FIELD BOOK _____		<p align="center">CITY OF SACRAMENTO DEPARTMENT OF PUBLIC WORKS</p>			<p>MARK THOMAS</p>		IMPROVEMENT PLANS FOR FLORIN ROAD VISION ZERO LAYOUTS		SHEET 6 OF 10	
REVISIONS																																
NO.	DESCRIPTION	DATE	BY																													
SCALE HORIZ. 1"=40' VERT. _____		DRAWN BY: J. FLORDELIZ DATE 12/1/2023		DESIGNED BY: J. FLORDELIZ DATE 12/1/2023		CHECKED BY: A. SILVA R.C.E. 75938 DATE 12/1/2023		UNDER THE SUPERVISION OF: AARON SILVA R.C.E. 75938 EXP. 12-31-24		PIN: XXX																						

GENERAL NOTES SIGNING AND STRIPING:

- ALL WORK SHALL BE DONE IN ACCORDANCE WITH: CITY OF SACRAMENTO DESIGN & PROCEDURES MANUAL, DATED SEPTEMBER 1990. CITY STANDARD SPECIFICATIONS, DATED JUNE 2007, CALTRANS STANDARD PLANS, 2015 EDITION AND THE CALIFORNIA MANUAL ON UNIFORM TRAFFIC CONTROL DEVICES (CA MUTCD), 2014 EDITION.
- THIS PLAN IS ACCURATE FOR SIGNING AND STRIPING WORK ONLY.
- ALL EXISTING SIGNING, STRIPING, AND MARKINGS TO REMAIN, UNLESS OTHERWISE NOTED. CONFLICTS BETWEEN EXISTING AND PROPOSED SHALL BE RESOLVED BY THE ENGINEER.
- EXACT POSITION AND LOCATION OF ALL ROADSIDE SIGNS SHALL BE DETERMINED IN THE FIELD BY THE ENGINEER.
- REMOVAL OF EXISTING STRIPING AND PAVEMENT MARKINGS, SHALL BE ACCOMPLISHED BY SANDBLASTING OR OTHER APPROVED GRINDING METHOD.
- CROSSWALKS SHALL BE 12 FEET WIDE INCLUDING THE 12" SOLID PAVEMENT MARKINGS AND SHALL BE WHITE.
- ALL SIGNING AND STRIPING WORK SHALL BE COORDINATED WITH THE ELECTRICAL WORK AS DIRECTED BY THE ENGINEER.
- LANE WIDTHS ADJACENT TO CURBS ARE MEASURED TO THE FACE OF CURBS.
- TRAFFIC SIGNS SHALL BE INSTALLED BEHIND THE SIDEWALK WHEN THE SIDEWALK IS IMMEDIATELY ADJACENT TO THE CURB. SIGNS SHALL BE INSTALLED BETWEEN THE CURB AND SIDEWALK WHEN THE SIDEWALK IS DETACHED. SIGN IN PEDESTRIAN AREAS SHALL HAVE A CLEARANCE FROM THE GROUND OF AT LEAST SEVEN FEET. IF THIS CLEARANCE REQUIREMENT IS NOT SATISFIED AFTER THE INSTALLATION OF ADDITIONAL SIGN PANELS, CONTRACTOR SHALL INSTALL A NEW SIGN POST.
- ALL STREET NAME SIGNS (R1, R2, W SERIES, AND SCHOOL ZONE SIGNS) SHALL INCLUDE ASTM TYPE IX SHEETING. FOR ALL OTHER SIGNS, USE ASTM TYPE I OR TYPE III SHEETING. SCHOOL ZONE SIGNAGE SHALL BE FLUORESCENT YELLOW-GREEN WHERE YELLOW IS INDICATED IN THE MUTCD.
- MOUNT SIGNS USING BANDING ON SIGNAL AND STREET LIGHT POLES WHERE FEASIBLE. SEE ELECTRICAL PLANS FOR POLE LOCATIONS.
- CONTRACTOR SHALL VERIFY WITH THE ENGINEER THE EXACT STREET NAME AND STREET ADDRESS FOR PLACEMENT ON STREET NAME SIGNS PRIOR TO ORDERING SIGNS.
- ALL SIGNS REGULATING PARKING SHALL BE DOUBLE SIDED AND SIDE MOUNTED.
- AT NEWLY SIGNALIZED LOCATIONS, REMOVE EXISTING STOP SIGNS, STOP LEGENDS AND STANCHIONS AT THE TIME SIGNAL IS TURNED ON.
- SPECIAL BIKE LANE TREATMENT SHALL BE CYCLEGRIP MMAX METHYL METHACRYLATE RESIN WITH AGGREGATE OR APPROVED EQUAL.
- GREEN BIKE MARKINGS TO BE PLACED FROM CURB TO GUTTER LIP. COLORED PAVEMENT MARKING TO NOT BE PLACED IN GUTTER.

LEGEND:

- ◆ REMOVE EXISTING ROADSIDE SIGN
- EXISTING ROADSIDE SIGN TO REMAIN
- * INSTALL ROADSIDE SIGN
- ▲ RELOCATE ROADSIDE SIGN
- RESET ROADSIDE SIGN
- ⊙ EXISTING ROADSIDE SIGN LOCATION
- ⊕ ROADSIDE SIGN LOCATION (ONE-POST)
- BC/EC
- △ ANGLE POINT
- ⊙(No) MUTCD STRIPING DETAIL NUMBER
L=XX'
- ◆(No) REMOVE EXISTING TRAFFIC STRIPING OR PAVEMENT MARKING
- ⊙(B) BUS STOP LOCATION
- ⊕(R) RAILROAD CROSSING PAVEMENT MARKING (PER MUTCD FIGURE 8B-7(CA))
- ⊙(No) MUTCD EXISTING STRIPING DETAIL NUMBER
- ⊕(No) REMOVE EXISTING TRAFFIC STRIPING OR PAVEMENT MARKING

SIGNING AND STRIPING NOTES:

- INSTALL 24" LIMIT LINE PER DETAIL 2, THIS SHEET
- INSTALL CONTINENTAL CROSSWALK PER DETAIL 1, THIS SHEET
- INSTALL MEDIAN NOSE SIGNS & MARKERS PER CITY STANDARD DETAIL T-250
- INSTALL MEDIAN NOSE SIGNS & MARKERS PER CITY STANDARD DETAIL T-260

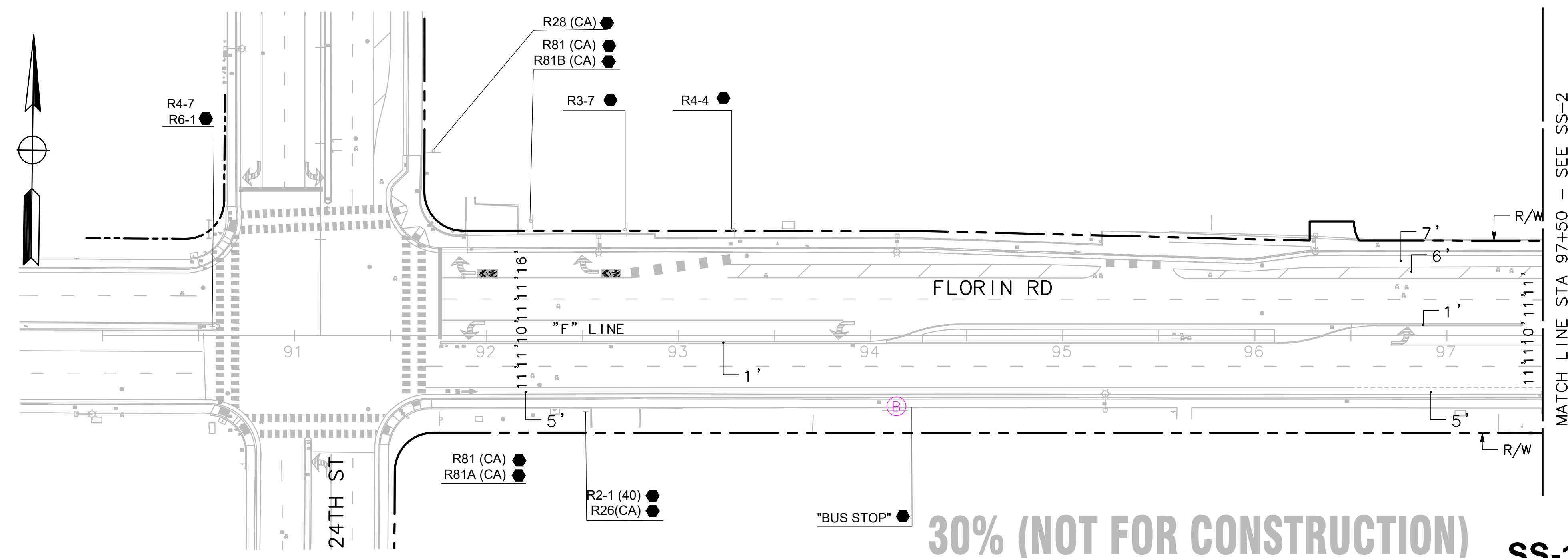
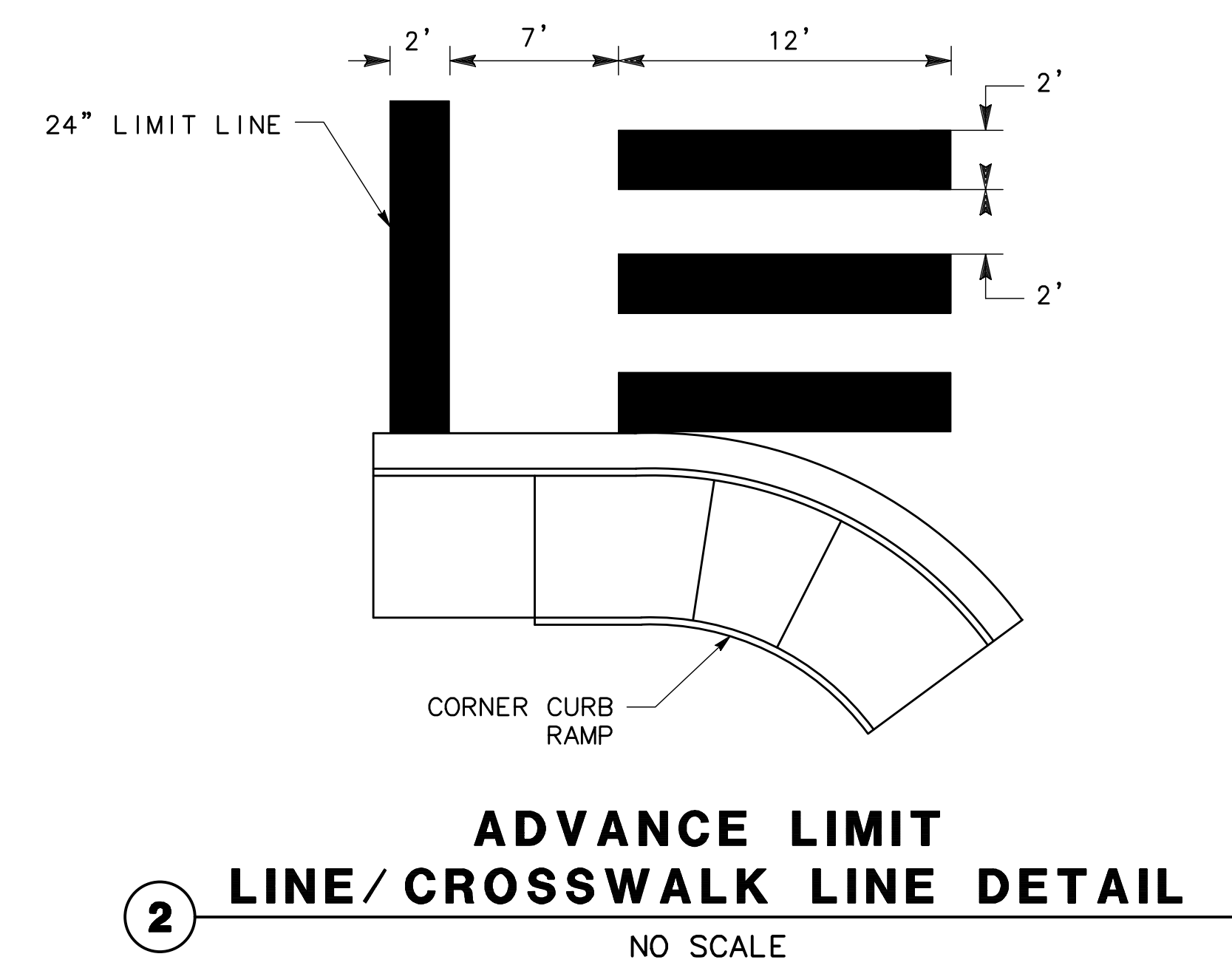
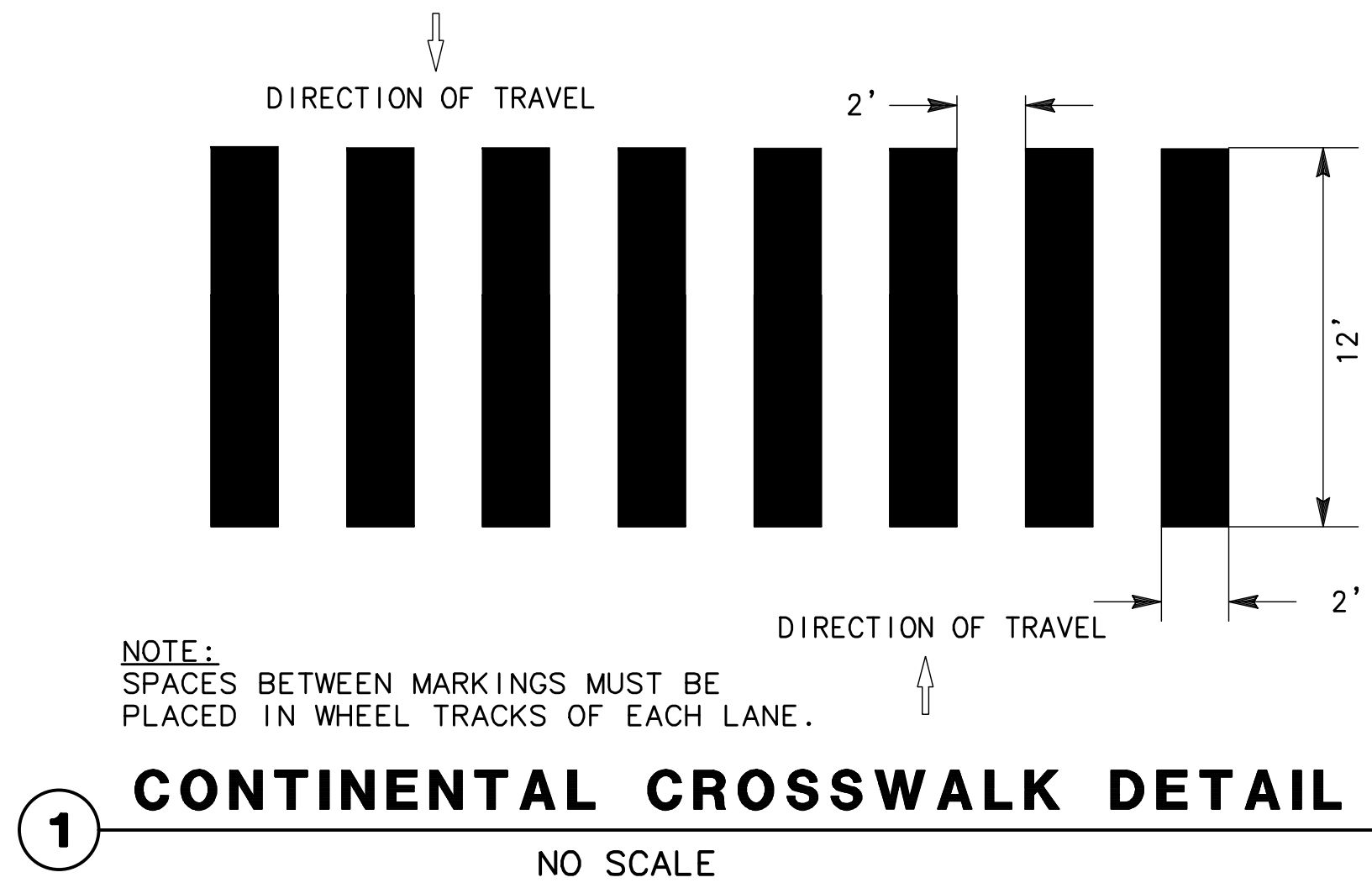

REVISIONS NO. DESCRIPTION DATE BY		BENCH MARK ELEV. _____		FIELD BOOK		CITY OF SACRAMENTO DEPARTMENT OF PUBLIC WORKS		MARK THOMAS UNDER THE SUPERVISION OF: AARON SILVA		IMPROVEMENT PLANS FOR FLORIN ROAD VISION ZERO SIGNING AND STRIPING		SHEET 7 OF 10	
SCALE HORIZ. 1"=40' VERT. _____		DRAWN BY: J. FLODELIZ DATE 12/1/2023		DESIGNED BY: J. FLODELIZ DATE 12/1/2023		CHECKED BY: A. SILVA R.C.E. 75938 DATE 12/1/2023		R.C.E. 75938 EXP. 12-31-24		PN: XXX		SS-1	

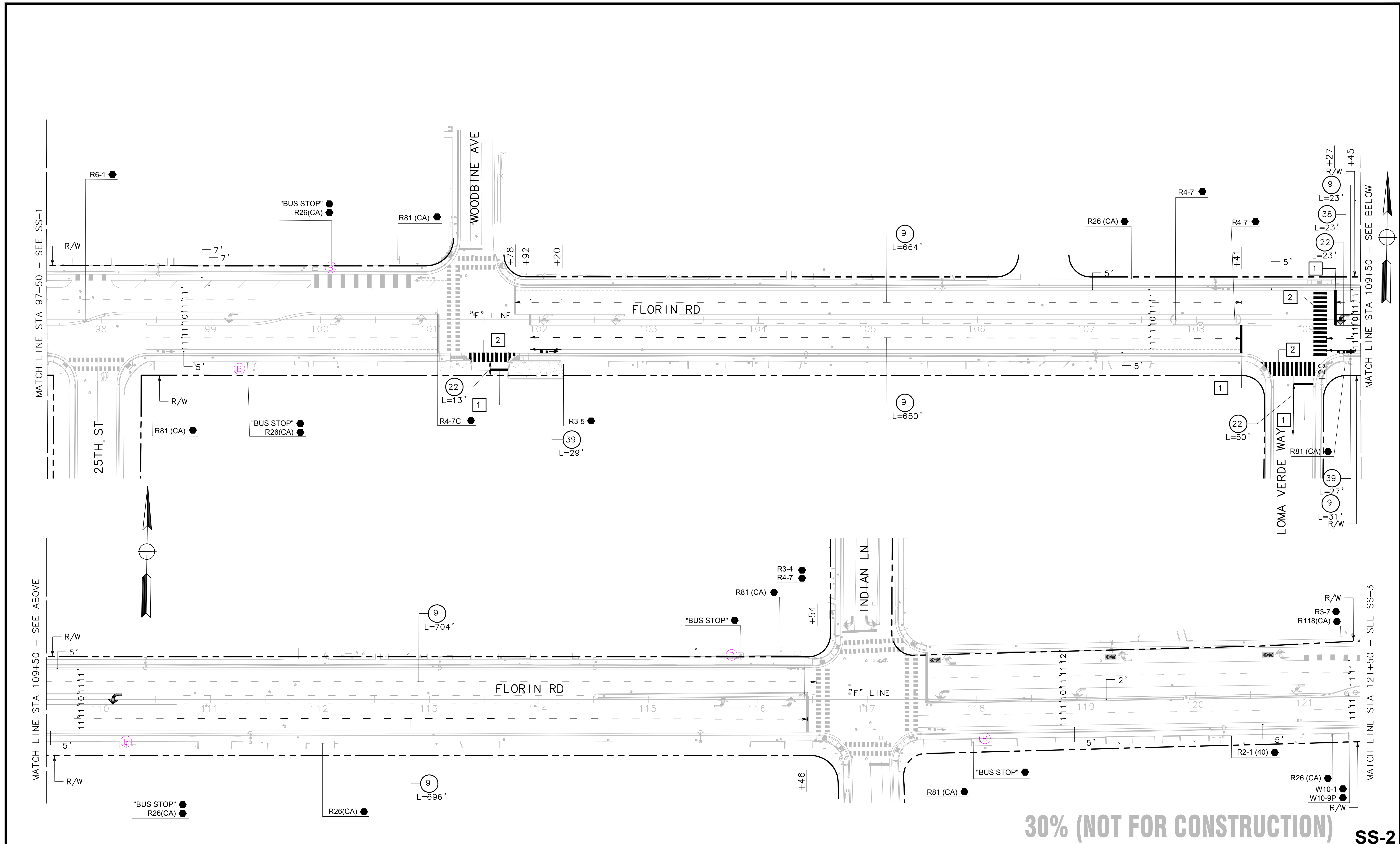

30% (NOT FOR CONSTRUCTION)

SS-2

REVISIONS			
NO.	DESCRIPTION	DATE	BY

BENCH MARK	ELEV.	
------------	-------	--

FIELD BOOK	
SCALE	
HORIZ. 1"=40'	
VERT.	

CITY OF SACRAMENTO			
DEPARTMENT OF PUBLIC WORKS			
DRAWN BY: J. FLORDELIZ	DESIGNED BY: J. FLORDELIZ	CHECKED BY: A. SILVA	R.C.E. 75938
DATE 12/1/2023	DATE 12/1/2023	DATE 12/1/2023	EXP. 12-31-24

MARK THOMAS

UNDER THE SUPERVISION OF:
AARON SILVA

R.C.E. 75938
EXP. 12-31-24

IMPROVEMENT PLANS FOR
FLORIN ROAD VISION ZERO
SIGNING AND STRIPING

PN: XXX	SHEET	8
	OF	10

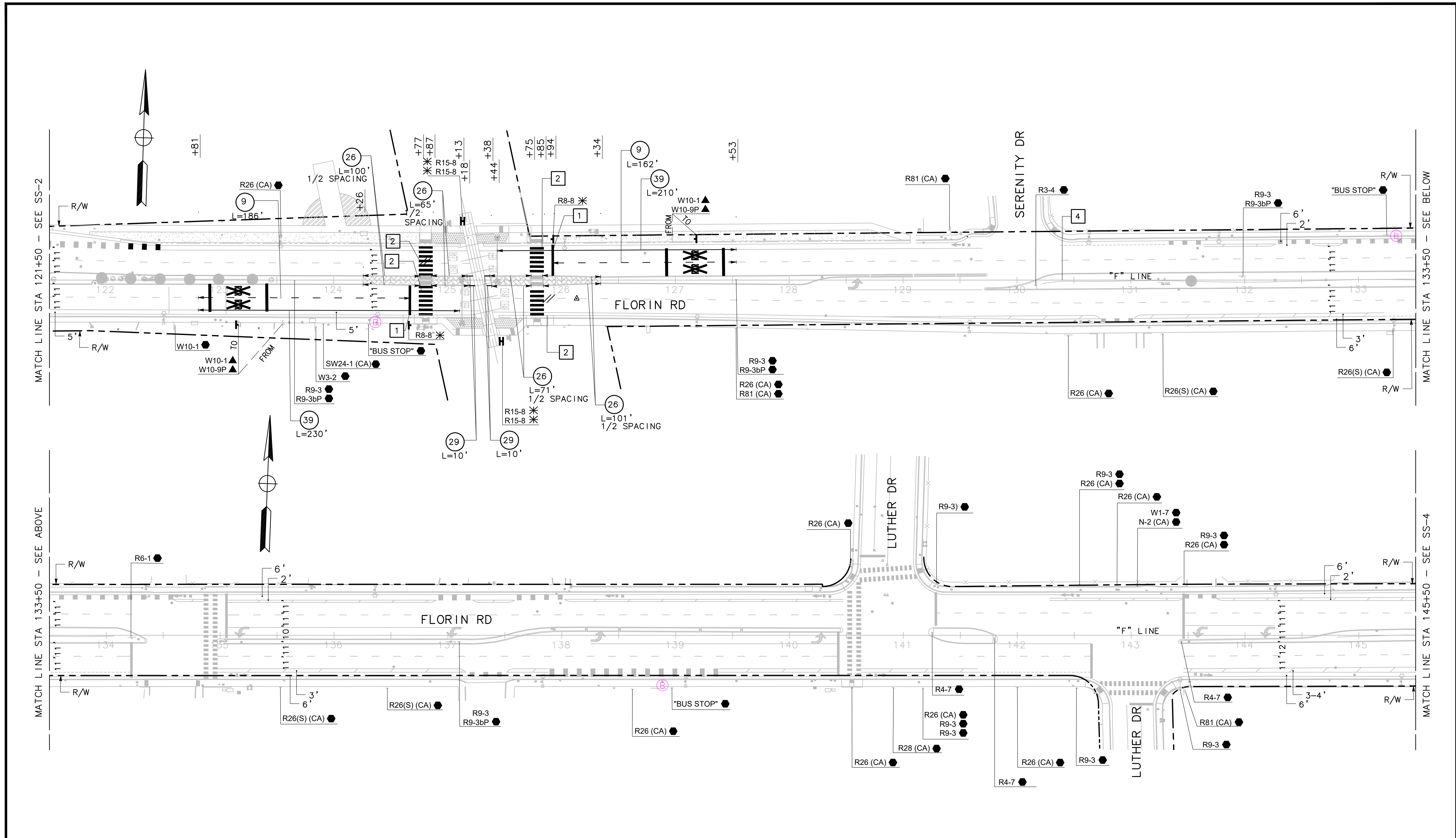

30% (NOT FOR CONSTRUCTION)

SS-3

REVISIONS			
NO.	DESCRIPTION	DATE	BY

BENCH MARK	ELEV.	
------------	-------	--

FIELD BOOK	
SCALE	
HORIZ. 1"=40'	
VERT.	

CITY OF SACRAMENTO
DEPARTMENT OF PUBLIC WORKS

DRAWN BY: J. FLORDELIZ	DESIGNED BY: J. FLORDELIZ	CHECKED BY: A. SILVA
DATE 12/1/2023	DATE 12/1/2023	R.C.E. 75938 DATE 12/1/2023

MARK THOMAS

UNDER THE SUPERVISION OF:
AARON SILVA

R.C.E. 75938
EXP. 12-31-24

IMPROVEMENT PLANS FOR
FLORIN ROAD VISION ZERO
SIGNING AND STRIPING

SHEET	9
	OF
PN: XXX	10

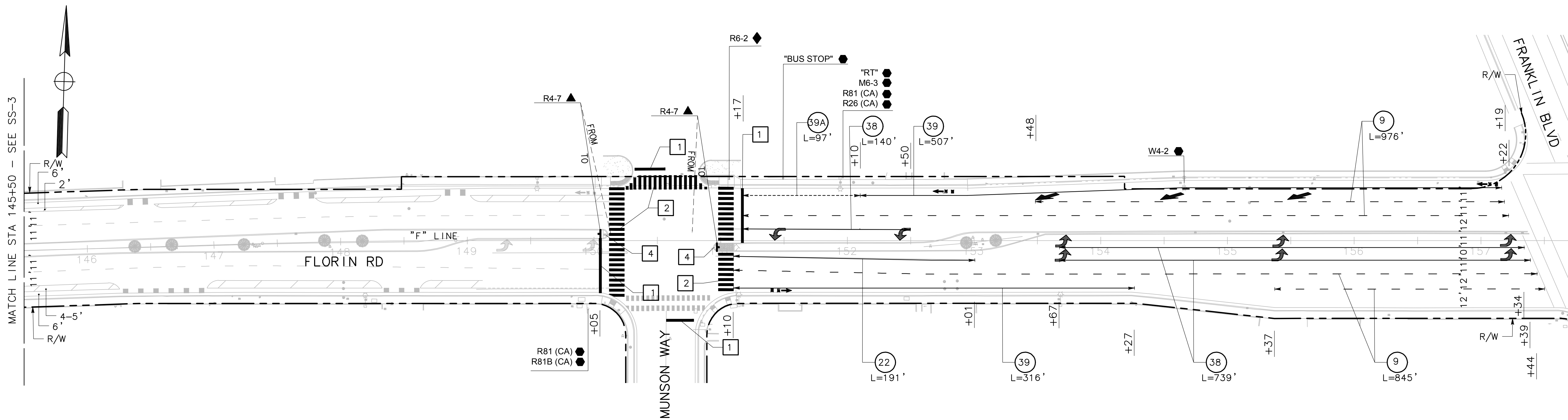

30% (NOT FOR CONSTRUCTION) **SS-4**

REVISIONS NO. DESCRIPTION DATE BY			BENCH MARK ELEV. _____		FIELD BOOK _____		CITY OF SACRAMENTO DEPARTMENT OF PUBLIC WORKS			 MARK THOMAS		IMPROVEMENT PLANS FOR FLORIN ROAD VISION ZERO SIGNING AND STRIPING			SHEET 10 OF 10	
							SCALE HORIZ. 1"=40' VERT. _____			UNDER THE SUPERVISION OF: AARON SILVA		R.C.E. 75938 EXP. 12-31-24			PN: XXX	
							DRAWN BY: J. FLODELIZ DATE 12/1/2023			DESIGNED BY: J. FLODELIZ DATE 12/1/2023		CHECKED BY: A. SILVA R.C.E. 75938 DATE 12/1/2023				



Ricardo Navarro

Date: 05/06/26

A dark blue silhouette of the Sacramento skyline and the Golden Gate Bridge, set against a light blue background.

Florin Road Vision Zero Safety

(T15215800)

Project Location

- Florin Road from 24th Street to Franklin Boulevard.
- 1.3 miles
- District 5 and 8

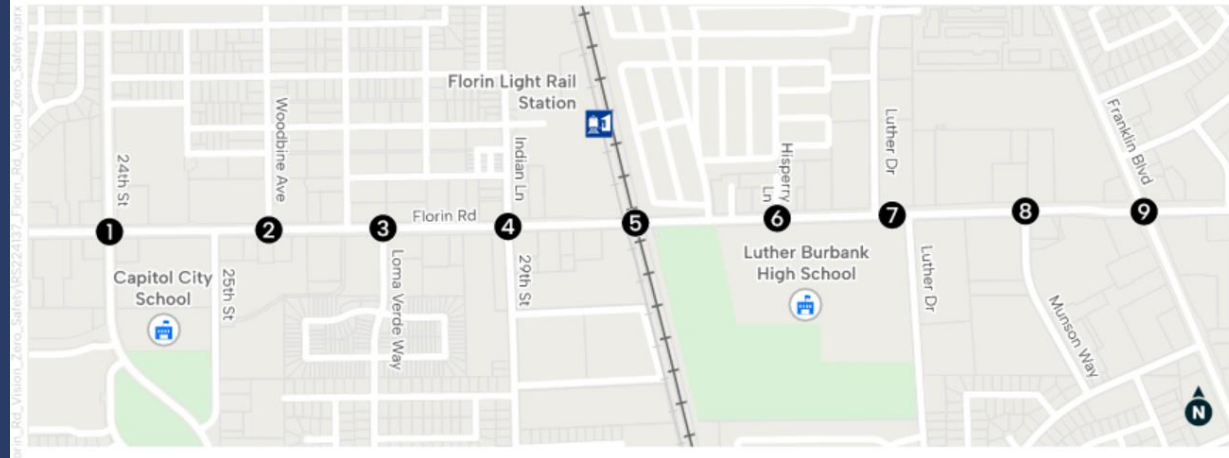

Purpose, Need, and Funding Sources

- Project goals:
 - Improve safety for all users along Florin Road
- Location selection:
 - City of Sacramento's Vision Zero Action Plan
 - City of Sacramento's Top 5 Corridor Study
- Senate Bill 1 Local Partnership Program (LPP)
 - Florin Road Vision Zero Safety phase 1
- Federal Regional Surface Transportation Program (RSTP)
 - Florin Road Vision Zero Safety phase 2



Existing Conditions

- Two eastbound/westbound vehicle travel lanes
- Eastbound/Westbound Class II bike lanes
- Railroad Crossing
- 40 MPH posted speed limit
- Limited crosswalks



Proposed Improvements

- Bicycle lane gap closures
- Bulbouts
- ADA compliant Curb Ramps
- Leading Pedestrian Intervals
- Updating and realigning Crosswalks
- New Traffic Signals



Location 2

- Florin Road & Woodbine Avenue (Signal Modification)
- Update to latest City standard to include vehicle preemption, CCTV equipment and video detection.
- New APS Push Buttons, New streetlighting and signal head modifications.

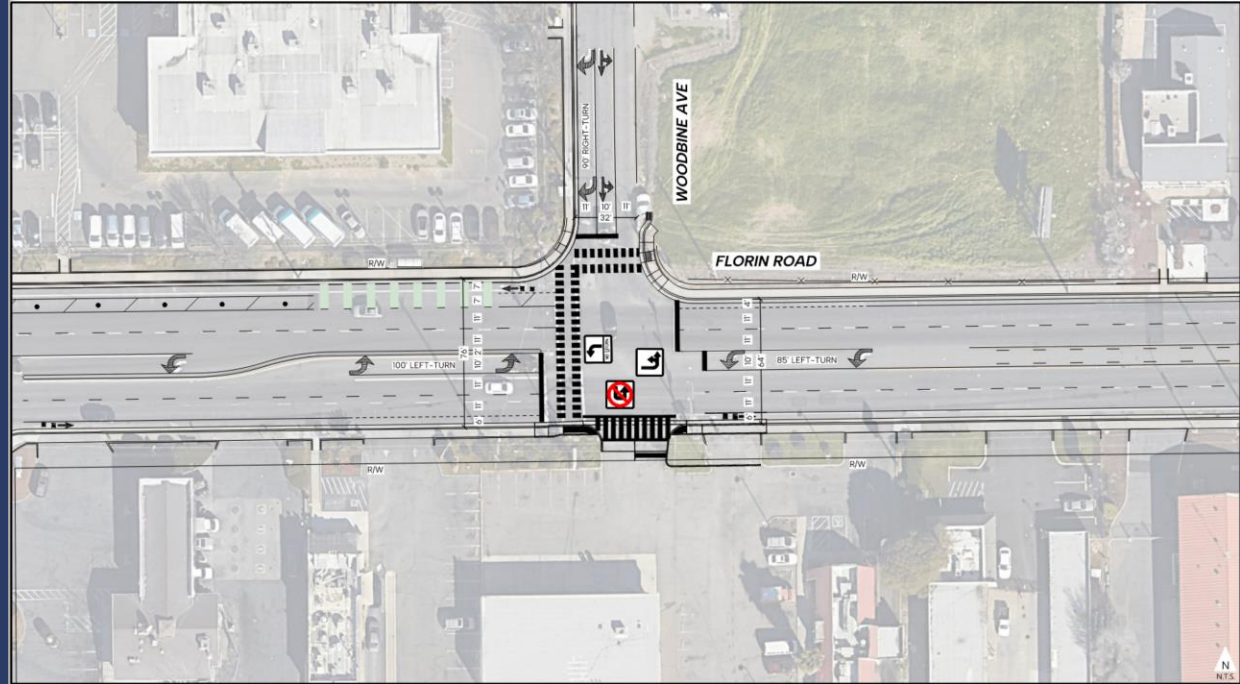

Location 3

- Florin Road & Loma Verde Way (New Traffic Signal)
- New Crosswalks, and New ADA Curb Ramps.
- Eastbound and Westbound U-turns will be restricted.

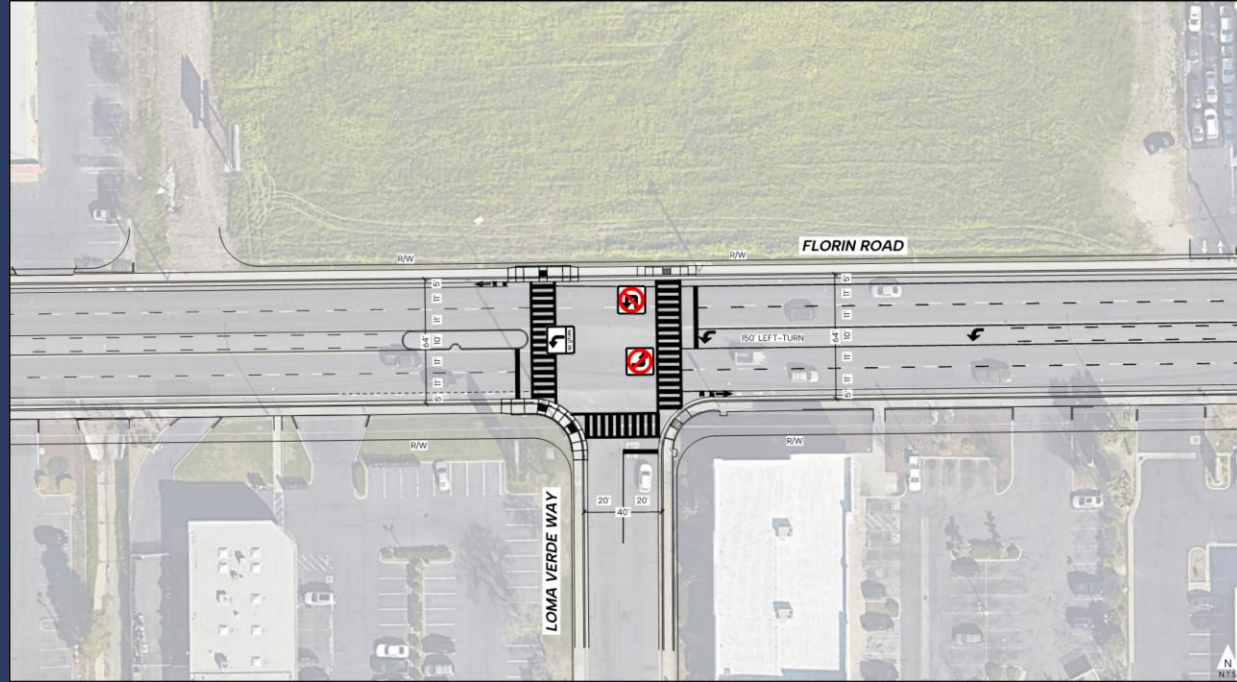

Location 4

- Florin Road & 29th Street/Indian Lane (Signal Modification)
- Update to latest City standard to include vehicle preemption, CCTV equipment and video detection.
- Implementation of protected left-turns for Indian Lane.

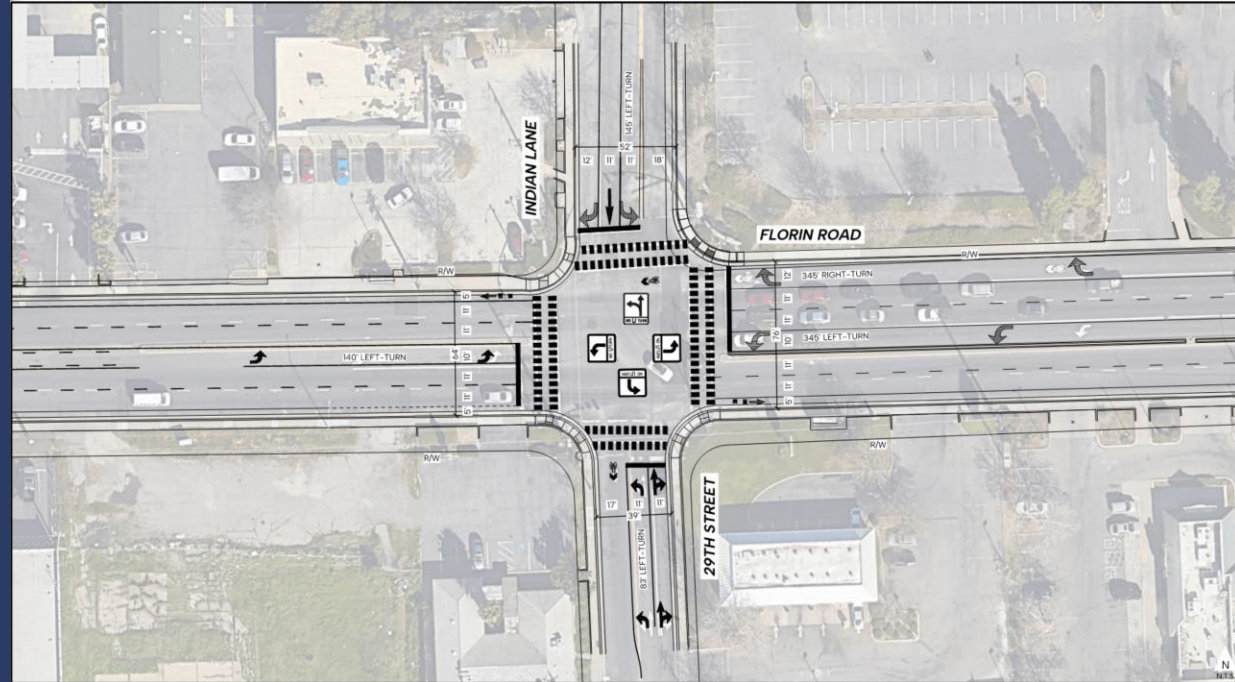

Location 5

- Florin Road & UPRR Queue-Cutter (New Traffic Signal)
- Pedestrian signal with protected crossings. Pedestrian refuge median included.
- Pedestrian crossings will be realigned and upgraded.
- Loop detection to prevent queuing on tracks.

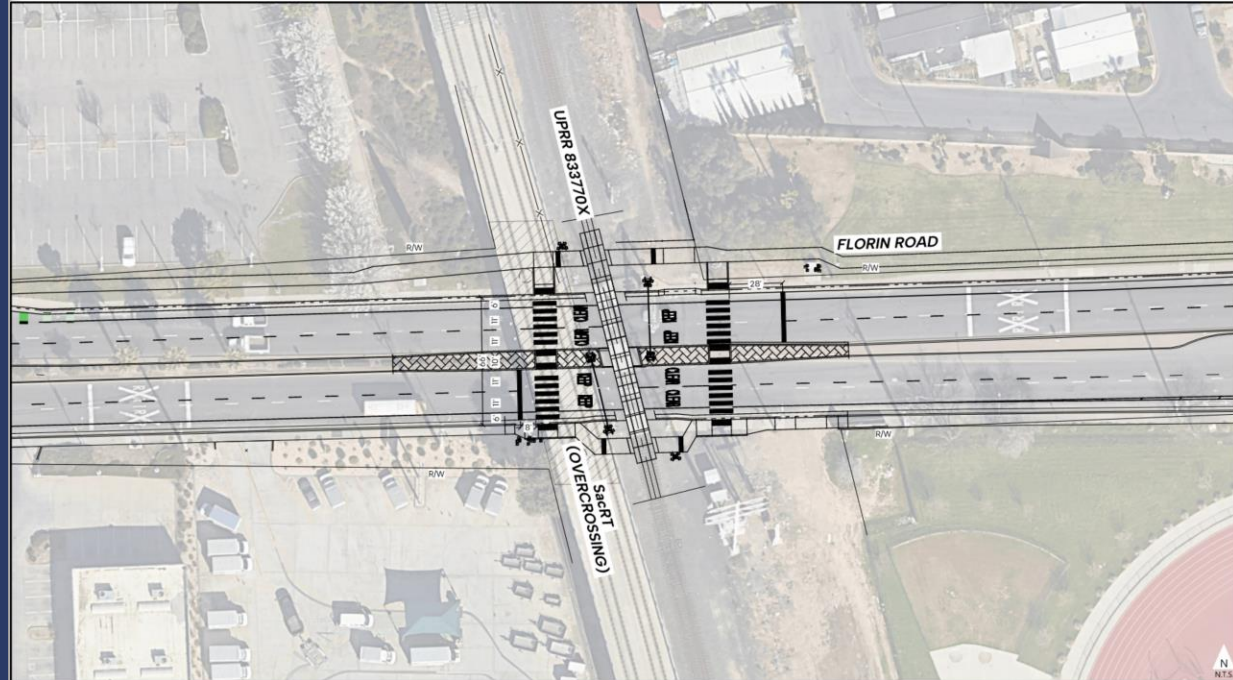

Location 6

- Florin Road & Hisperry Lane/Luther Burbank High School (Signal Modification)
- Update to latest City standard to include vehicle preemption, CCTV equipment and video detection.
- Existing North and South approaches will be signalized.

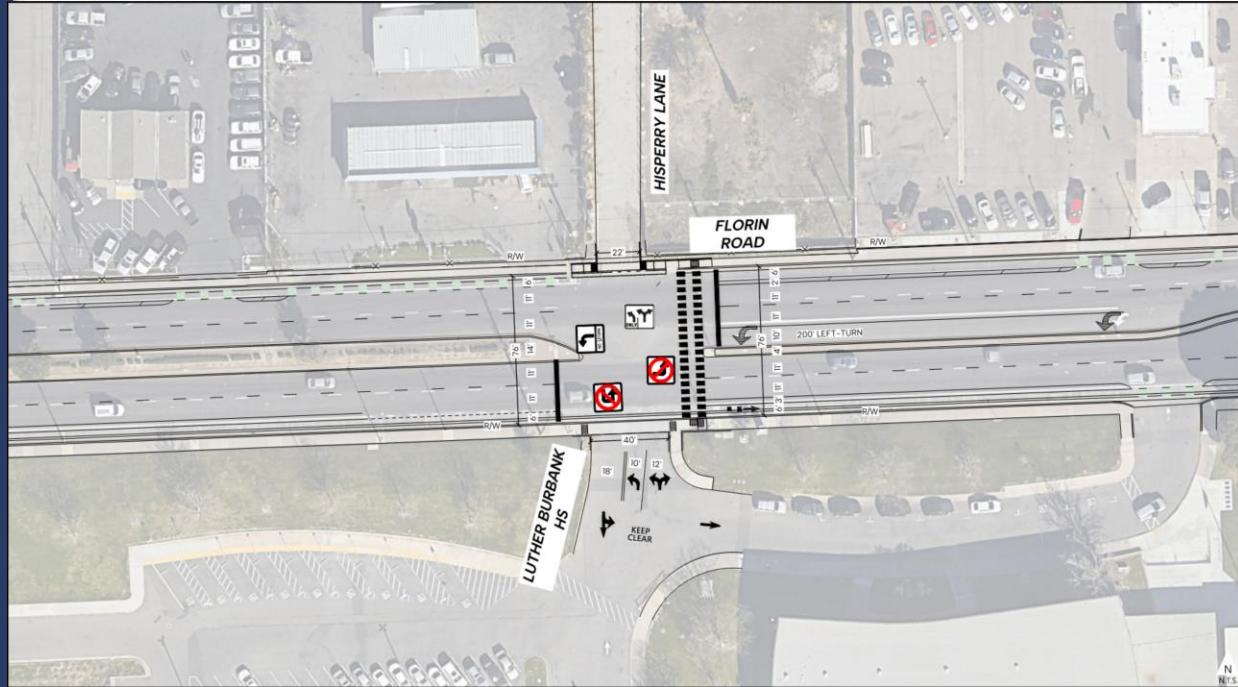

Location 7

- Florin Road & Luther Drive (Signal Modification)
- Update to latest City standard to include vehicle preemption, CCTV equipment and video detection.
- New Safety Lighting

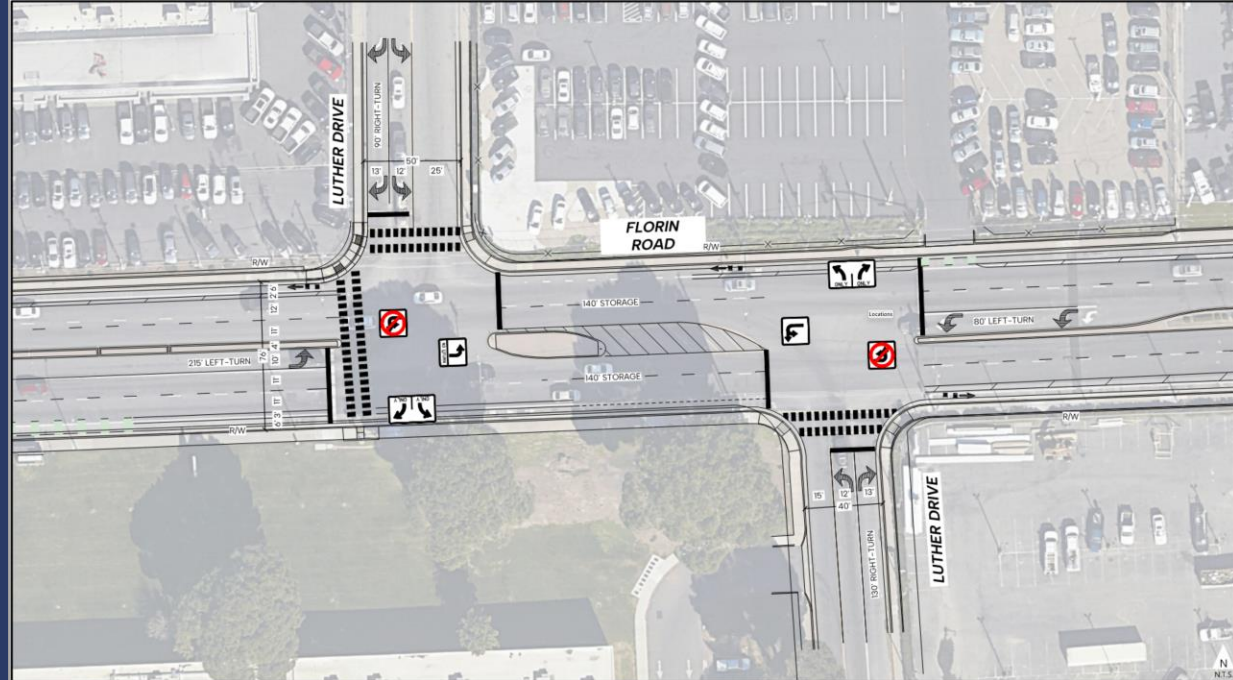

Location 8

- Florin Road & Munson Way
(New Pedestrian Signal)
- New crosswalk, refuge median



Location 9

- Florin Road & Franklin Boulevard (Signal Modification)
- New APS Push Buttons, New streetlighting and signal head modifications.
- Green paint treatment, Road widening to install bike lanes, repurpose existing travel lanes.

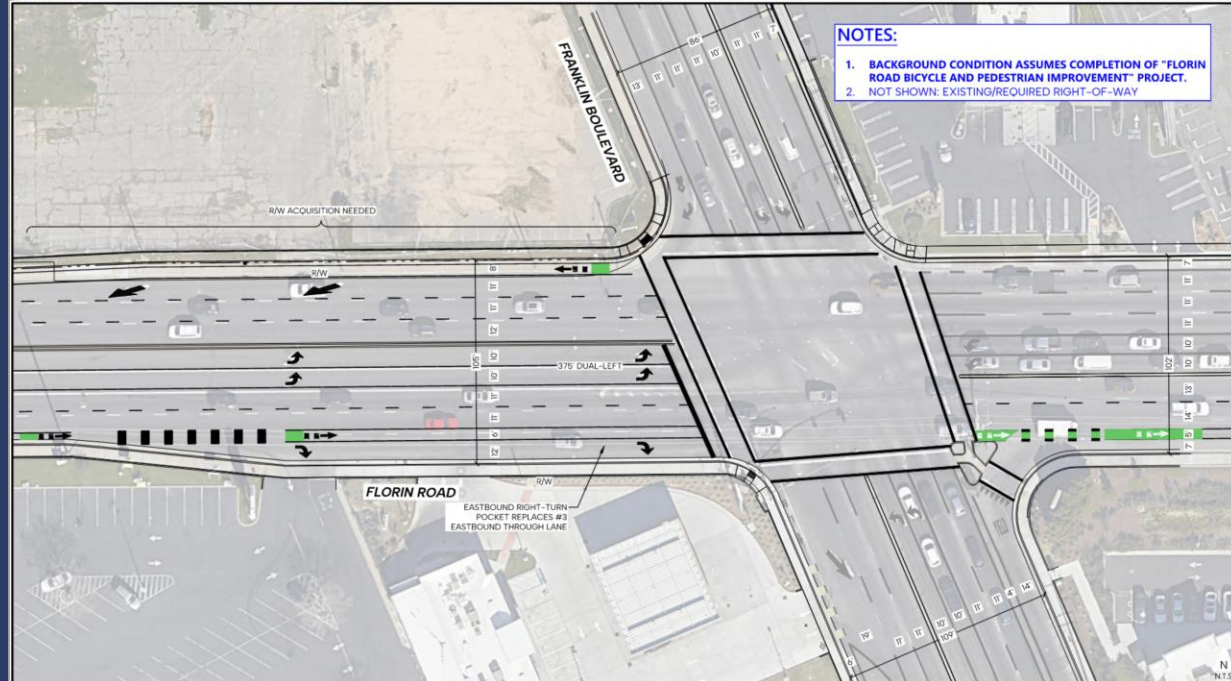

Project Timeline

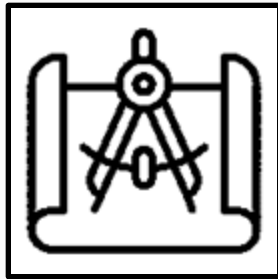

Design

Complete Feb 2027

&

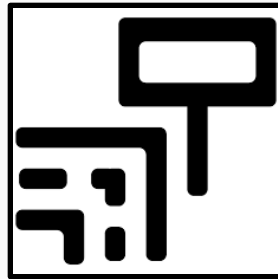

Right of Way

Complete Feb 2027

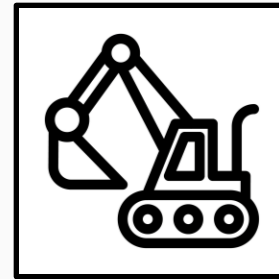

Construction

July of 2027

Thank you!

Project Manager:

Ricardo Navarro

City of Sacramento - Public Works
915 I St
Sacramento, CA

rnavarro@cityofsacramento.org
(916) 642-4854

City of
SACRAMENTO



GENERAL NOTES:

1. ALL STATION AND OFFSET CALLOUTS REFERENCE THE "F" LINE UNLESS OTHERWISE NOTED.
2. STATION AND OFFSET CALLOUTS ARE TO THE FLOWLINE UNLESS OTHERWISE NOTED.

LEGEND:

-  BUS STOP LOCATION
-  SAWCUT
-  TEXTURED PAVING
-  REMOVE MEDIAN
-  MINOR CONCRETE
-  DECOMPOSED GRANITE
-  LANDSCAPING
-  SLURRY SEAL
-  Exist TRAFFIC SIGNAL
-  Prop TRAFFIC SIGNAL

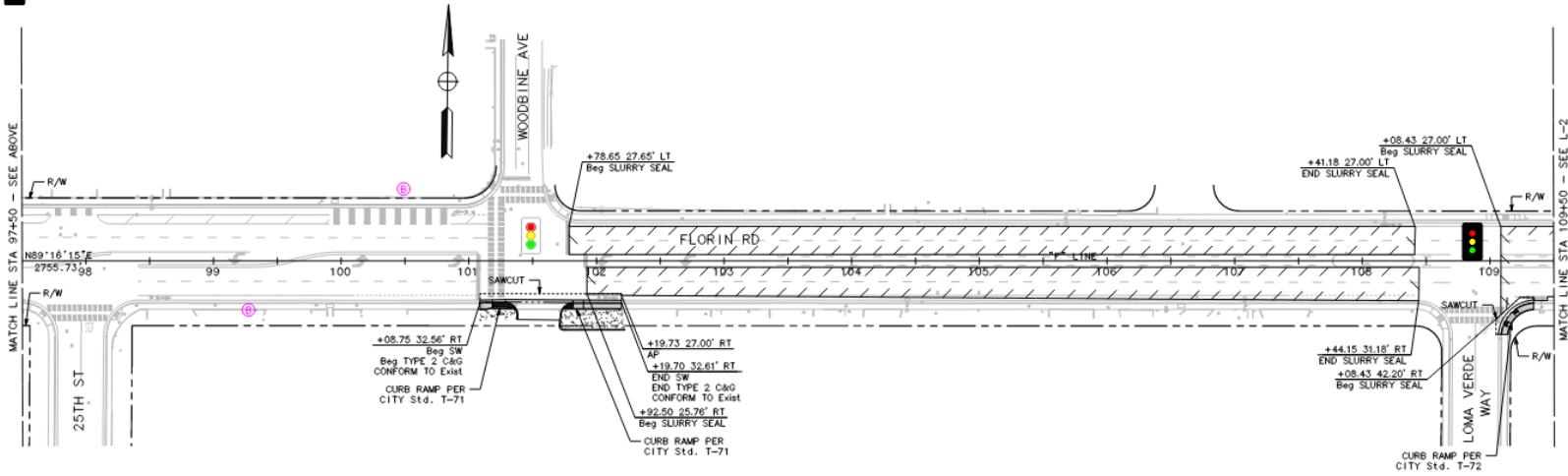
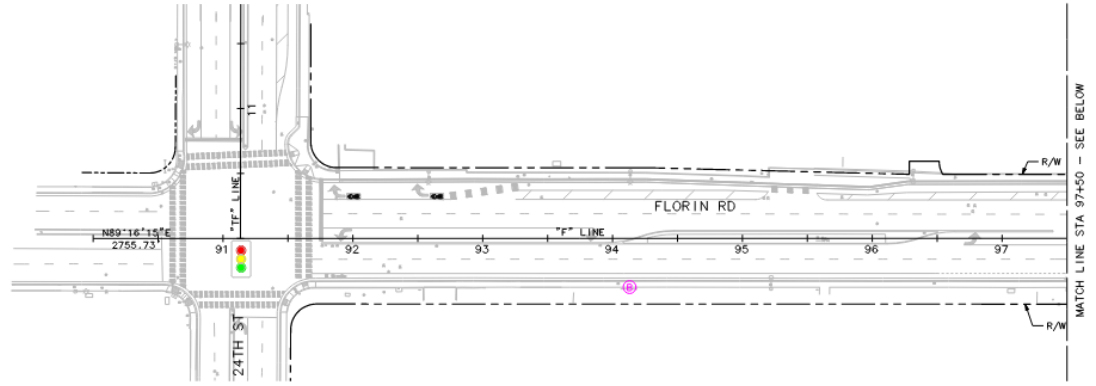

30% (NOT FOR CONSTRUCTION)

L-1

GENERAL NOTES:

1. ALL STATION AND OFFSET CALLOUTS REFERENCE THE "F" LINE UNLESS OTHERWISE NOTED.
2. STATION AND OFFSET CALLOUTS ARE TO THE FLOWLINE UNLESS OTHERWISE NOTED.

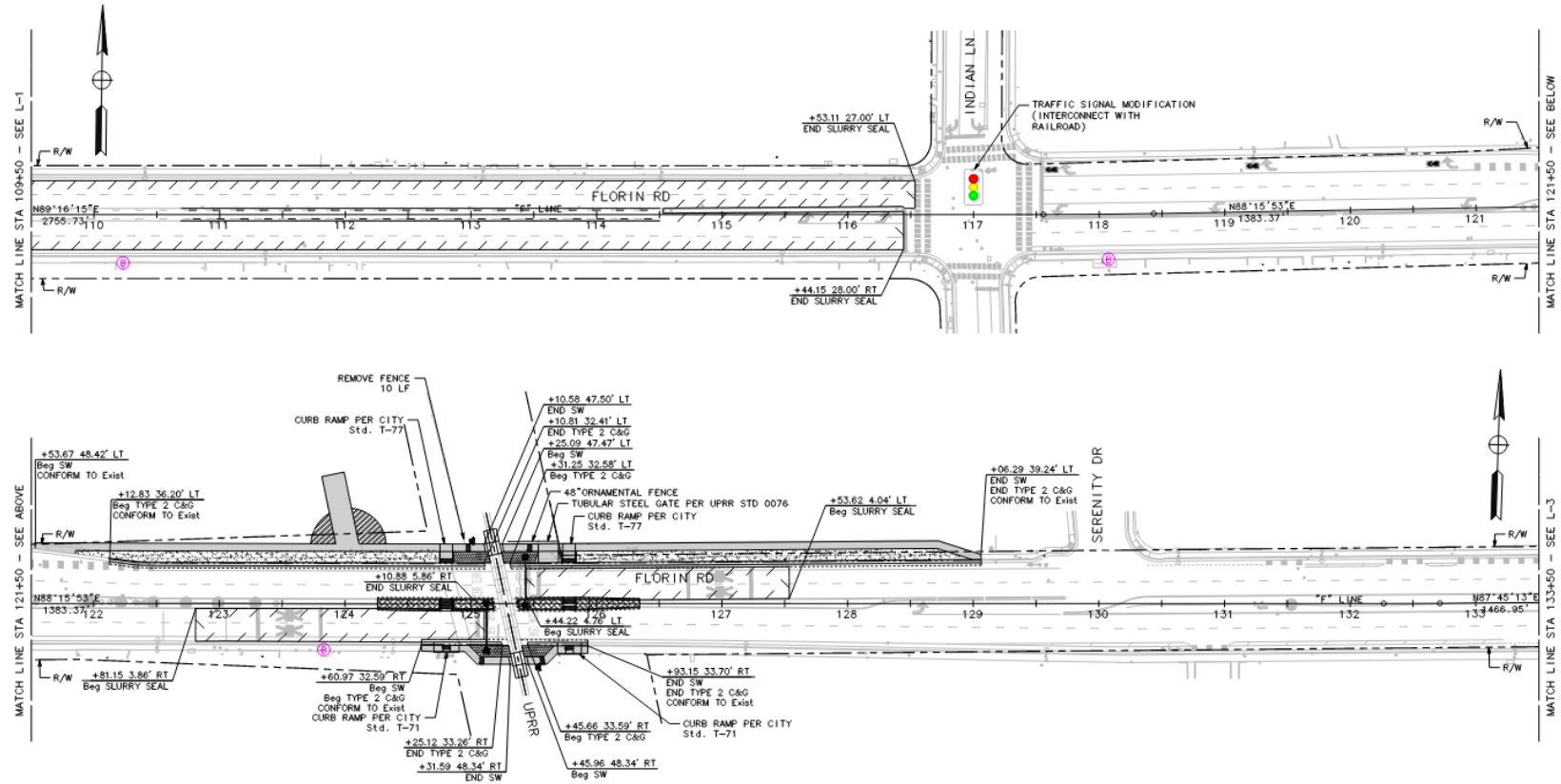

30% (NOT FOR CONSTRUCTION)

GENERAL NOTES:

1. ALL STATION AND OFFSET CALLOUTS REFERENCE THE "F" LINE UNLESS OTHERWISE NOTED.
2. STATION AND OFFSET CALLOUTS ARE TO THE FLOWLINE UNLESS OTHERWISE NOTED.

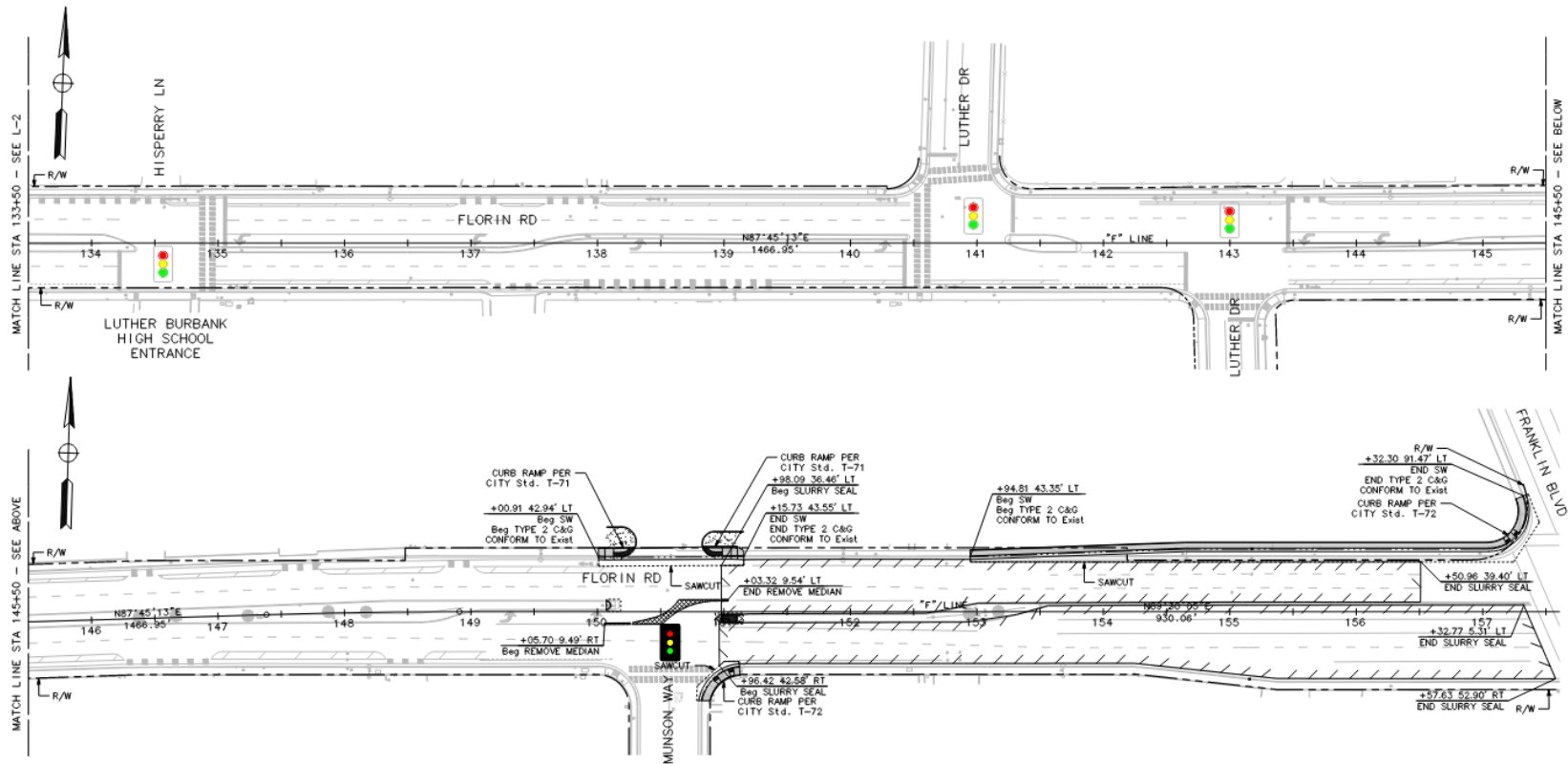

30% (NOT FOR CONSTRUCTION)

GENERAL NOTES SIGNING AND STRIPING:

- ALL WORK SHALL BE DONE IN ACCORDANCE WITH: CITY OF SACRAMENTO DESIGN & PROCEDURES MANUAL, DATED SEPTEMBER 1990, CITY STANDARD SPECIFICATIONS, DATED JUNE 2007, CALTRANS STANDARD PLANS, 2015 EDITION AND THE CALIFORNIA MANUAL ON UNIFORM TRAFFIC CONTROL DEVICES (CA MUTCD), 2014 EDITION.
- THIS PLAN IS ACCURATE FOR SIGNING AND STRIPING WORK ONLY.
- ALL EXISTING SIGNING, STRIPING, AND MARKINGS TO REMAIN, UNLESS OTHERWISE NOTED. CONFLICTS BETWEEN EXISTING AND PROPOSED SHALL BE RESOLVED BY THE ENGINEER.
- EXACT POSITION AND LOCATION OF ALL ROADSIDE SIGNS SHALL BE DETERMINED IN THE FIELD BY THE ENGINEER.
- REMOVAL OF EXISTING STRIPING AND PAVEMENT MARKINGS, SHALL BE ACCOMPLISHED BY SANDBLASTING OR OTHER APPROVED GRINDING METHOD.
- CROSSWALKS SHALL BE 12 FEET WIDE INCLUDING THE 12" SOLID PAVEMENT MARKINGS AND SHALL BE WHITE.
- ALL SIGNING AND STRIPING WORK SHALL BE COORDINATED WITH THE ELECTRICAL WORK AS DIRECTED BY THE ENGINEER.
- LANE WIDTHS ADJACENT TO CURBS ARE MEASURED TO THE FACE OF CURBS.
- TRAFFIC SIGNS SHALL BE INSTALLED BEHIND THE SIDEWALK WHEN THE SIDEWALK IS IMMEDIATELY ADJACENT TO THE CURB. SIGNS SHALL BE INSTALLED BETWEEN THE CURB AND SIDEWALK WHEN THE SIDEWALK IS DETACHED. SIGN IN PEDESTRIAN AREAS SHALL HAVE A CLEARANCE FROM THE GROUND OF AT LEAST SEVEN FEET. IF THIS CLEARANCE REQUIREMENT IS NOT SATISFIED AFTER THE INSTALLATION OF ADDITIONAL SIGN PANELS, CONTRACTOR SHALL INSTALL A NEW SIGN POST.
- ALL STREET NAME SIGNS (R1, R2, W SERIES, AND SCHOOL ZONE SIGNS) SHALL INCLUDE ASTM TYPE 1X SHEETING. FOR ALL OTHER SIGNS, USE ASTM TYPE 1 OR TYPE III SHEETING. SCHOOL ZONE SIGNAGE SHALL BE FLUORESCENT YELLOW-GREEN WHERE YELLOW IS INDICATED IN THE MUTCD.
- MOUNT SIGNS USING BANDING ON SIGNAL AND STREET LIGHT POLES WHERE FEASIBLE. SEE ELECTRICAL PLANS FOR POLE LOCATIONS.
- CONTRACTOR SHALL VERIFY WITH THE ENGINEER THE EXACT STREET NAME AND STREET ADDRESS FOR PLACEMENT ON STREET NAME SIGNS PRIOR TO ORDERING SIGNS.
- ALL SIGNS REGULATING PARKING SHALL BE DOUBLE SIDED AND SIDE MOUNTED.
- AT NEWLY SIGNALIZED LOCATIONS, REMOVE EXISTING STOP SIGNS, STOP LEGENDS AND STANCHIONS AT THE TIME SIGNAL IS TURNED ON.
- SPECIAL BIKE LANE TREATMENT SHALL BE CYCLEGRIP MMAX METHYL METHACRYLATE RESIN WITH AGGREGATE OR APPROVED EQUAL.
- GREEN BIKE MARKINGS TO BE PLACED FROM CURB TO GUTTER LIP. COLORED PAVEMENT MARKING TO NOT BE PLACED IN GUTTER.

LEGEND:

- ◆ REMOVE EXISTING ROADSIDE SIGN
- EXISTING ROADSIDE SIGN TO REMAIN
- ✳ INSTALL ROADSIDE SIGN
- ▲ RELOCATE ROADSIDE SIGN
- RESET ROADSIDE SIGN
- ▲ EXISTING ROADSIDE SIGN LOCATION
- ▲ ROADSIDE SIGN LOCATION (ONE-POST)
- BC/EC
- △ ANGLE POINT
- (No) MUTCD STRIPING DETAIL NUMBER
- L=XX' L= LENGTHS
- (No) BUS STOP LOCATION
- ✳ RAILROAD CROSSING PAVEMENT MARKING (PER MUTCD FIGURE 8B-7(CA))
- (No) MUTCD EXISTING STRIPING DETAIL NUMBER
- //— REMOVE EXISTING TRAFFIC STRIPING OR PAVEMENT MARKING

SIGNING AND STRIPING NOTES:

- INSTALL 24" LIMIT LINE PER DETAIL 2, THIS SHEET
- INSTALL CONTINENTAL CROSSWALK PER DETAIL 1, THIS SHEET
- INSTALL MEDIAN NOSE SIGNS & MARKERS PER CITY STANDARD DETAIL T-250
- INSTALL MEDIAN NOSE SIGNS & MARKERS PER CITY STANDARD DETAIL T-260

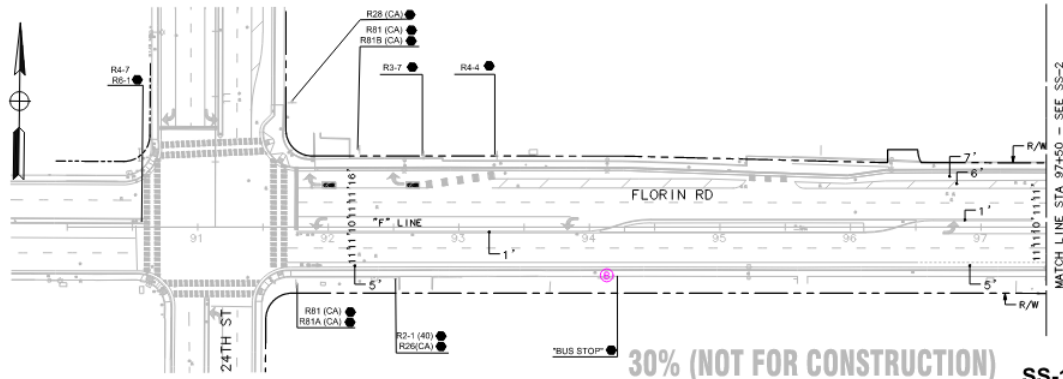
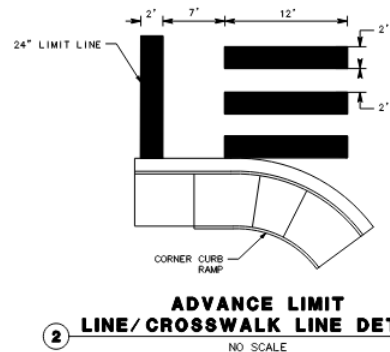
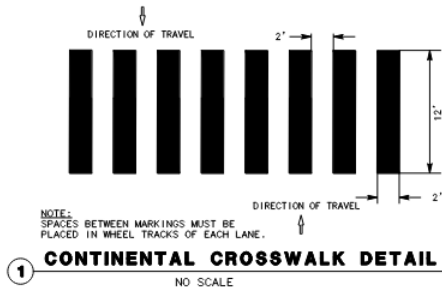

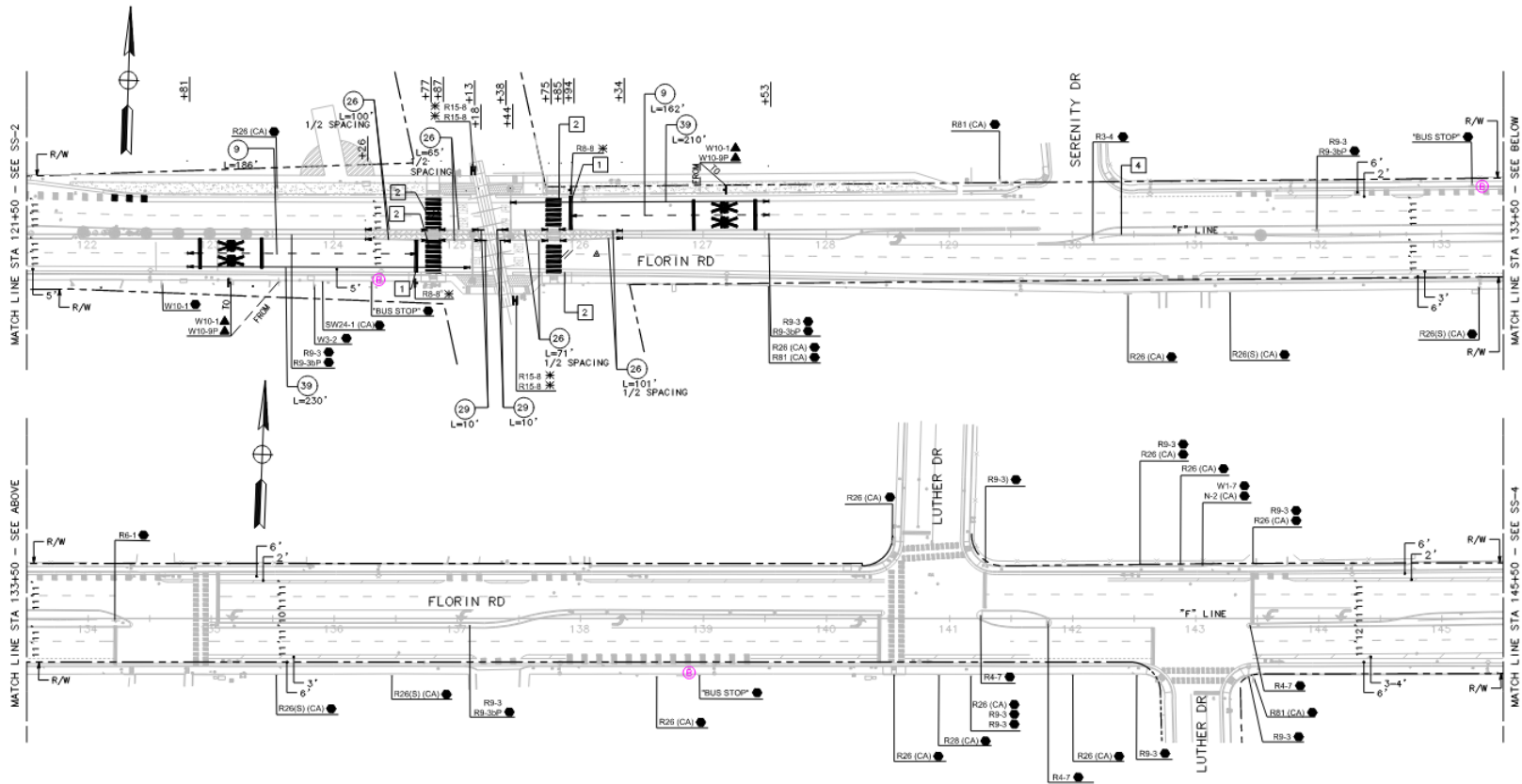

30% (NOT FOR CONSTRUCTION) SS-3

